

Four Winns

Four Winns Catalog

1991 BOATING LIFESTYLES

PRICELESS



WINNING EDGE 5/3/1:
THE BEST JUST GOT EVEN BETTER.

To protect your investment, Four Winns offers the most comprehensive owner protection programs in boating.



A NEW 5-YEAR HULL STRUCTURAL WARRANTY* offered to give you and your family piece of mind while you're on the water.

3-YEAR WHOLE BOAT OWNER PROTECTION* covering all major Four Winns boat systems and components, the OMC Cobra® and OMC King Cobra® stern drive, or Johnson® or Evinrude® outboard power system, and the custom Four Winns Sure Load™ trailer for one year of limited warranty followed by two years extended protection.

NEW 1-YEAR THEFT/ACCIDENT/LIABILITY COVERAGE. Every Four Winns boat has been insured under a policy that provides theft, liability, and accidental damage coverage with a deductible charge for each claim.

You may choose to continue this coverage for up to 1 year for a \$15 processing fee paid to the insurance broker.

Since all plans are transferable to subsequent owners, up to the limits of the original warranty or certificate, you'll have extra piece of mind if you sell your Four Winns boat – so will the family that buys it.



FOUR WINNS®

* Ask your dealer for complete details.

FOUR WINNS CATALOG

PRICELESS

FourWinns

DEAR FAMILY BOATER...

It's a pleasure to welcome you to Four Winns, a full line producer of fiberglass powerboats – third largest in the world based on units sold each year. The boats in this catalog – runabouts, deck boats, cuddys, cruisers and performance boats – as well as Quest by Four Winns fishing boats and Four Winns wide-body cruisers, share a common design principle: These are family boats...sized and equipped to suit family boating lifestyles...well-constructed to provide a stable and secure platform for your most precious cargo...and affordably priced to put fun on the water within reach of every family. Happy boating in 1991 and...

...GIVE YOUR  FAMILY OUR BEST.

INSIDE FRONT COVER Four Winns' exclusive
Winning Edge™ 5/3/1 owner protection...the best gets even better!

4 The class of the value class is still Four Winns Freedom™...
170, 190 runabouts and 195 cuddy.

8 180, 200, and 220 Horizon™
sportboats...you can pay more, but
you can't buy more sportboat.

14 Party of 13...your boat is ready! Four Winns Candia™
deck boats are packed with adventure.

16 When the sun sets, Four Winns
Sundowner™ cuddy cruisers
really shine.

22 Four Winns all-new 235 Vista
cruiser...graceful new entry
into the live-a-board class...

All Four Winns boats in this brochure are designed for maximum family-oriented enjoyment on the water. The symbols below represent typical boating activities. Look for them on the individual model pages as a quick reference to boating lifestyle.



Boats displaying this symbol are well suited for daytime water activities.



This boat features a cuddy cabin to allow you to sleep onboard for short stays on the water.



This "liveaboard" includes or can be equipped with the basic amenities you'll need for extended cruising.



Two waves designate a boat which is recommended for protected waters; three waves indicate a boat which is suitable for open water; four waves mean that the boat is suitable for offshore cruising.



This is a trailerable boat. Ask your dealer for towing regulations that apply in your state or province.



Power options, a ski eye, and plenty of storage make this boat especially suited for watersports.



This model is available with an optional sport/fishing or fish and ski package.



Ask your dealer about the Four Winns product video brochures. Four Winns has developed all new informative, magazine-style video "brochures" for each boat series. These videos contain on-the-water footage of every model, information on product features, and comments from the boating press. Videos may be viewed upon request in your dealer's showroom, or borrowed for home viewing.

Winning Edge™ 5/3/1 Owner Protection Plan	inside front cover
Design & Engineering	page 2
Freedom™ runabouts	pages 4-7
Horizon™ sportboats	pages 8-13
Candia™ deck boats	pages 14-15
Sundowner™ cuddys	pages 16-21

Vista cruisers	pages 22-25
Liberator® performance boats	pages 26-31
The Power of OMC	pages 32-33
Canvas & color options	pages 34-35
Options & accessories	page 36
Your Four Winns Professional Marine Retailer	back cover

An important note about information in this catalog...Every effort has been made to insure that this catalog includes complete and accurate information. However, since the time of printing, some information may have been revised. Also some equipment shown on Four Winns boats within this catalog is available at extra cost. Since we do reserve the right to make changes at any time, without notice, in prices, colors, equipment, specifications and models, we suggest that you check with your Four Winns dealer for complete and current information. OMC Cobra® OMC King Cobra® OMC Sea Drive® Johnson® Evinrude® and VRO™ are registered trademarks of Outboard Marine Corporation. Four Winns / 4 Winn Way / Cadillac, MI 49601 / (616) 775-1351

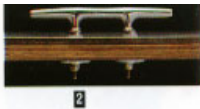

1. Patented, modular seat system components can be replaced, repaired, or interchanged. The high density foam cushions, heavy gauge vinyl, breathable dura-web backing, and stainless staples and screws, well exceed industry standards.



2. Cleats are through-bolted and metal-backed.
3. Power is tested under a variety of conditions at our Test Center at Lake Cadillac.

ENGINEERING

Four Winns patented, modular seat design features a premium, marine-grade UV-treated vinyl – stain, mildew, and fade-resistant with “memory” to help retain its shape.

Our plush, fade- and mat-resistant carpet is absolutely the finest in terms of drying properties, durability, cut, and fit.

Slimline sidewall design adds inches of usable space to the cockpit. Sidewall storage compartments are roomy, convenient.

Self-storing Sunbrella canvas convertible top is UV-treated, fade-resistant, and custom-sewn in our canvas shop for a snug, precise fit. Jump seats may be raised to form a sun deck, or removed completely. Quick-access engine compartments (I/Os) are sound-insulated.

Molded, in-floor gas tanks are 100% pressure-tested and fully-accessible for maintenance or repair.

Stainless, deep-access swim ladder. Stainless steel and corrosion-free materials such as high-strength plastics are used to provide maximum strength with minimum maintenance.

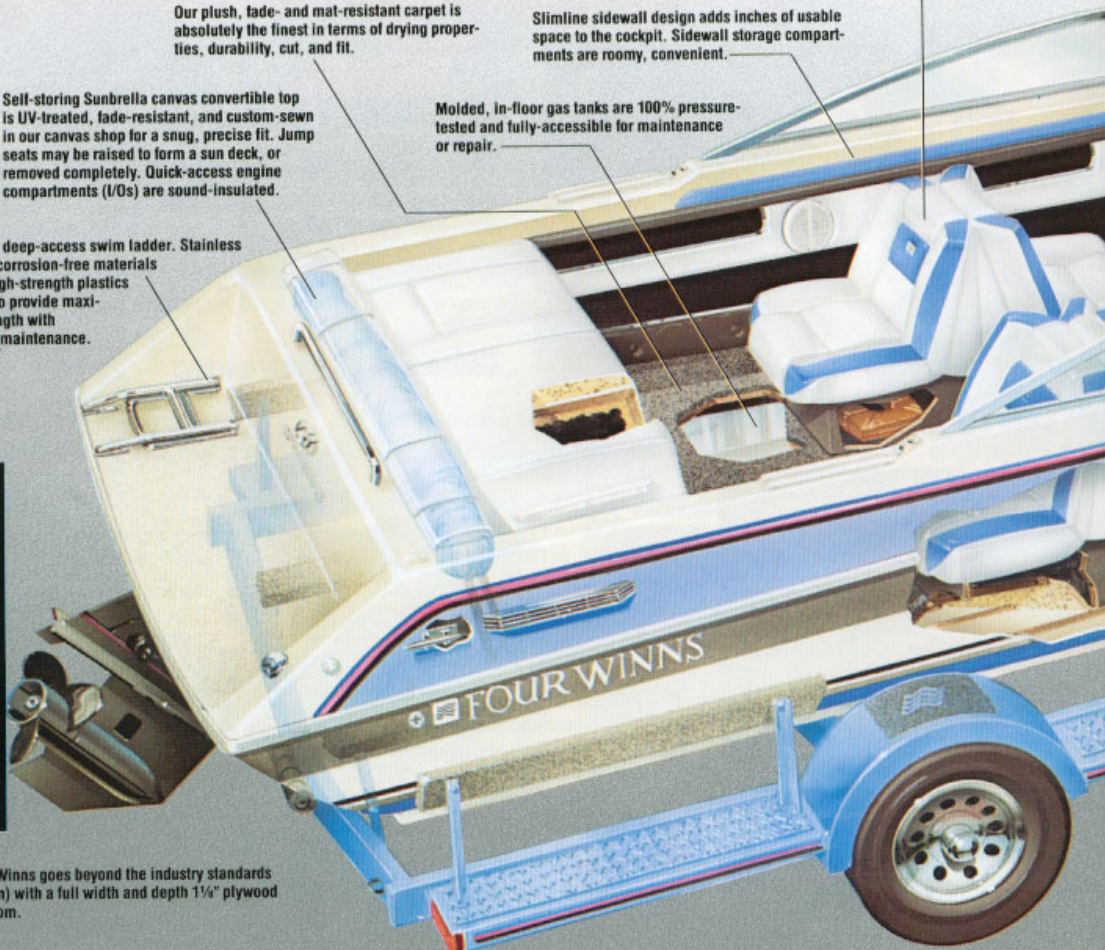

"There are no superstars here...

Team Four Winns is simply a gathering of highly motivated, deeply committed people – in every discipline – who understand that in order to build, promote, and sell quality boats with the style, features, and performance today's boaters expect, everyone's contribution is important, and required."

Four Winns goes beyond the industry standards (again) with a full width and depth 1 1/4" plywood transom.

Premium gelcoat is applied to optimum thicknesses. Looks better longer...buffs back to its original shine season after season. And Four Winns gives you more color choices than ever.

Four Winns boats are certified as having met the stringent quality standards of the National Marine Manufacturers Association... which means, in many cases, they exceed U.S. Coast Guard requirements.

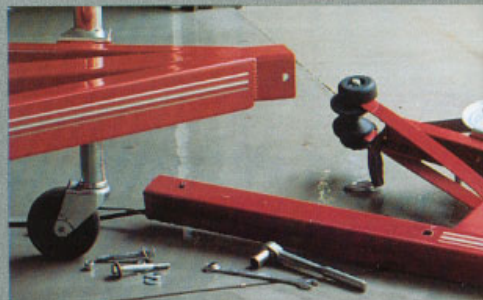

5



4. Every system on every boat is checked and water-tested in our test tank facilities.

4

Walk-through, wrap-around windshields are tempered. Passenger side console features lockable glove box and integrated cooler with overboard drain.

Wood backing at all through-the-hull-and-deck fastening points and through-bolting of cleats and rails to metal backing plates provides greater durability and strength.

Bow anchor locker with molded anchor well provides quick, easy access and holds anchor securely in place when not in use.

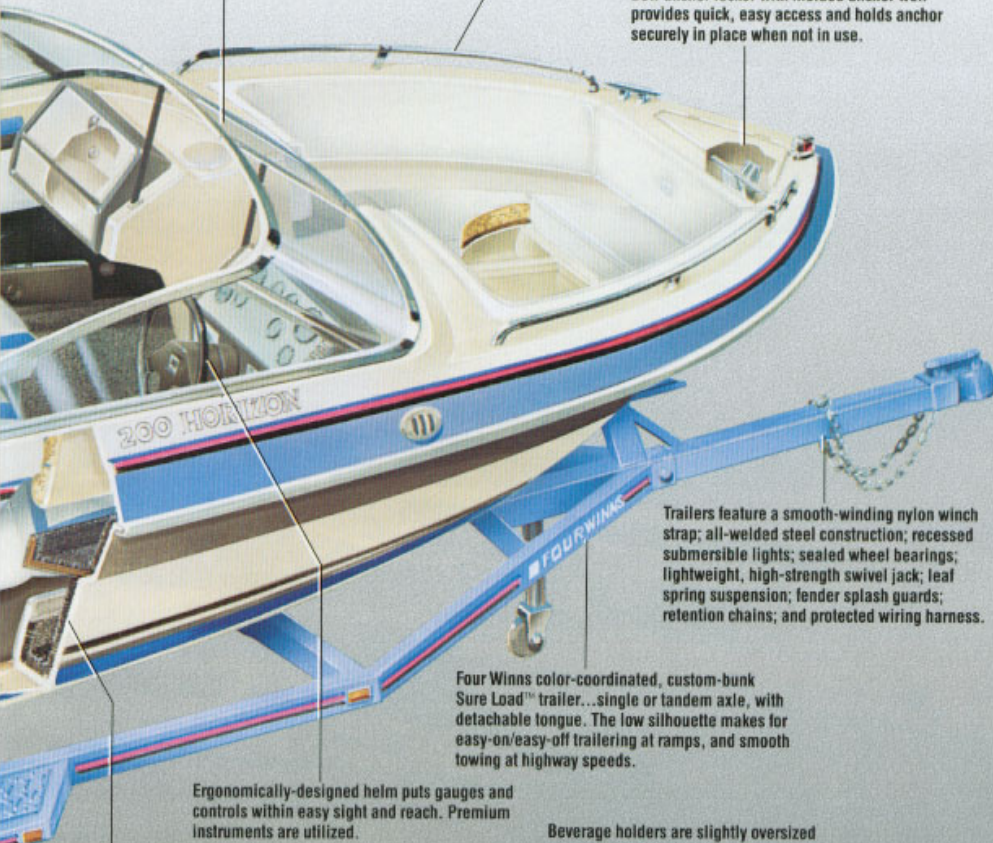

Trailers feature a smooth-winding nylon winch strap; all-welded steel construction; recessed submersible lights; sealed wheel bearings; lightweight, high-strength swivel jack; leaf spring suspension; fender splash guards; retention chains; and protected wiring harness.

Four Winns color-coordinated, custom-bunk Sure Load™ trailer...single or tandem axle, with detachable tongue. The low silhouette makes for easy-on/easy-off trailering at ramps, and smooth towing at highway speeds.

Ergonomically-designed helm puts gauges and controls within easy sight and reach. Premium instruments are utilized.

Beverage holders are slightly oversized to accommodate insulated can carriers.

Four Winns construction quality includes extra measures such as hand lay-up woven fiberglass, with coremat reinforcement at the bulkheads.

100% glass encapsulated, interlocking floor stringer system; advanced gunneling techniques; and closed cell foam flotation injected into the hull – not only prevent condensation below the waterline, but also make our boats stronger, and quieter.



6



7

5. All Four Winns trailers feature a detachable tongue which deters theft, and reduces the overall length to allow for garage storage in many cases.

6. Trailer winches feature a rugged nylon strap for smoother winding and greater reliability.

7. Four Winns color-matched Sure Load™ trailers are custom-fitted to each Four Winns model with bunks positioned directly beneath the stringers – cradling the boat where the hull is strongest.

GIVING YOU OUR BEST – EVERY STEP OF THE WAY.

While the theme, "Give Your Family Our Best," is the heartfelt credo of every member of Team Four Winns, it perhaps rings strongest among the people who design, engineer, and build the boats your family will enjoy. These are the individuals who innovate, test, and refine new products...who develop and adhere to quality standards...and who help make your boating experiences hassle-free and enjoyable.

Quality control is more than a catch-phrase at Four Winns. We take extra measures to continually improve and monitor the quality of our products, including:

- *Full systems check program* – all systems are 100% water-tested, and boats are cleaned, inspected, and shrink-wrapped before shipment. Factory-rigging by expert technicians means your boat is virtually water-ready upon arrival.
- Exacting quality standards are ensured by *statistical process control* – a system which keeps production quality variances to a minimum.
- Daily, boats in production are subjected to a *quality audit index* – the Four Winns standard of excellence.

Four Winns maintains exceptional control over every aspect of production – by designing our own hulls, building our own trailers, and working closely with propulsion experts at OMC who engineer and manufacture all the powerteams. Because of this integration, hull and engine deliver optimum performance and fuel economy...trailers provide better support...and – best of all – boat, motor, and trailer are backed by the same, hassle-free agreement – Four Winns exclusive *Winning Edge™ 5/3/1 Owner Protection Plan.**

*Ask your Four Winns dealer for full details.



1



2

1. Sure Load™ color-matched, custom-bunk trailer is standard.
2. Convenient bow access step and under-seat storage.
3. Integrated, oversized beverage holder, stereo speaker, and lockable, integrated, insulated cooler and glove box.



3



4

170/190 FREEDOM



"Dear pen pal, Well, you missed another great party. Your gift was a big hit though...Thanks ever so much for the fake green slime... After the cake, my mom built a big bonfire and we took turns telling spooky stories...a neighbor told us our screams and giggles carried for miles over the water...Maybe you will be able to come to my party next year..."

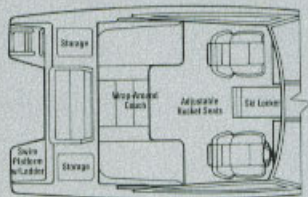

Std. Seating (OB)

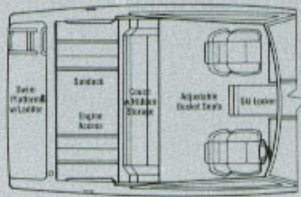

Brougham (I/O)

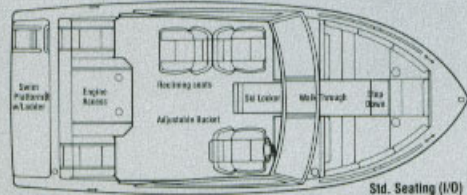

Std. Seating (I/O)



7

Four Winns Extra Value Standard Features

- Anchor locker w/molded anchor well (closed bow)
- Cleats, rails, ski-eye, through-bolted, metal-backed
- Deep cycle, high cranking marine battery w/retainer
- Easy maintenance gel coated bilge
- Emergency engine shut-off
- Engine compartment sound insulation (I/O)
- Ergonomically-designed helm for maximum convenience, comfort and safety



4. Convenient top storage compartment.
5. Fish and ski package is optional.
6. Brougham seating.
7. Complete instrumentation with padded wheel.



6

5



THE ONLY THING ENTRY-LEVEL ABOUT A FOUR WINNS FREEDOM IS THE PRICE.

Construction-wise, style-wise, and feature-wise, Four Winns Freedom™ models rank with much pricier runabouts. Consider...slimline sidewall design... plentiful storage...a stainless swim ladder and ski eye...self-storing canvas top...built-in cooler... Four Winns Sure Load™ trailer and *Winning Edge™* 5/3/1 Owner Protection. All of which make Four Winns 170, 170 Closed Bow, and 190 Freedom sportboats very wise choices, indeed.

Specifications	170	190
LGA/Transom to Bow:	18'6"/17'1"	19'8"/18'3"
Beam:	7'3"	7'3"
Fuel (gal.):	18	24
Max. Cruise Range (mi.):	80	110
Passengers:	(I/O) 7 (OB) 6	(I/O) 8 (OB) 7
Maximum Capacity (lbs.):	(I/O) 1050 (OB) 1600	(I/O) 1085 (OB) 1640
Bridge Clearance:	3'8"	3'8"
Cockpit Depth (helm):	30"	30"
Draft (drive down):	26"	29"
Trailer Weight, Empty (lbs.):	580	600

*Estimate. Actual Cruise Range may vary.

Power Rating & Weights	170	190		
Model	Crankshaft HP	Propshaft HP	Boat & Engine Weights	Boat & Engine Weights
90 M/L/V-4 (OB)	N/A	90 HP	1690	-
90TL/L-4 (OB)	N/A	90 HP	1700	-
120 TL/V-4 (OB)	N/A	120 HP	1760	1860
140 TL/V-4 (OB)	N/A	140 HP	-	1860
3.0L/L-4 (I/O)	130 HP	115 HP	2050	2140
3.0L-HO/L-4 (I/O)	150 HP	130 HP	2060	2170
4.3L/V-6 (I/O)	175 HP	150 HP	-	2290

N/A: Not applicable.

Model Availability
170 and 190 Outboard, 170 Outboard/Closed Bow,
170 and 190 Stern Drives, 170 Stern Drive/Closed Bow

Exclusive Winning Edge™ 5/3/1 Owner Protection Plan*: 5-year hull structural...3-year whole boat protection...1-year theft/accidental damage/liability coverage!
Four Winns Sure Load™ Trailer, single axle, custom bunk, color-coordinated, w/detachable tongue
Fuel tank, in-floor accessible
Full width & depth plywood transom
Hand lay-up woven fiberglass w/ coremat reinforcement at the bulkheads
Interlocking floor system
Maximum closed cell foam added for rigidity,

sound deadening, and level flotation
National Marine Manufacturers Association certification
Premium gel coat w/superior buff back characteristics
Premium marine carpet w/superior drying properties, durability, fade and mat resistance
Premium marine vinyl made to Four Winns specifications
Quick-access hinged engine compartment lid (I/O)
Shrink wrap shipping
Slimline sidewall design for maximum cockpit space

Smooth-riding, fast-planing deep-vee hull
Swim ladder, deep-access, 3-step
Ultraviolet-resistant, self-storing canvas convertible top
Wood backing at all through-the-hull-and-deck fastening points

Additional Standard Features
Exterior and Trim

- Cleats (4)
- Horn
- Navigation lights
- Swim platform, fiberglass, integrated w/ladder
- Windshield, tempered, bent glass, w/walk-through

Functional and Convenience

- Bilge blower (I/O)
- Bilge pump
- Bow access step
- Color-coded wiring
- Drain plug, brass
- Fused switches
- Instrumentation: (I/O) fuel, oil pres., trim ind., water temp., tachometer, speedometer, voltmeter, (OB) tachometer, speedometer, fuel, voltmeter, trim ind.
- Power steering (I/O)
- Power trim & tilt (I/O)
- Power trim, tilt & VRC™ (OB)
- Prop: aluminum

Steering wheel, soft-feel
Seating: snap-in bow seats, back-to-back seats (fold to lounge), adjustable driver's seat, jump seats remove or make sun deck (I/O), wrap-around stern lounge (OB)
Stereo AM/FM cassette in weather resistant box

Interior

- Beverage holders, oversized (cockpit)
- Courtesy lights (cockpit)
- Passenger console w/lockable glove box, integrated/insulated cooler w/ overboard drain
- Ski locker w/skag-trimmed cover
- Storage: bow area, sidewall, concealed top (I/O), floor (ski)

Major Options

- Brougham package (I/O)
- Custom fit canvas mooring cover
- Fish and ski package
- Full canvas package

*Ask your Four Winns dealer for full details.
 †Coverage may be continued to a 5th policy year for paid by the insurance broker.

5



1



2



3



4

1. Premium quality, UV-treated vinyl resists wear, tear, and weather.
2. Stereo AM/FM cassette.
3. Roomy double berth. Optional portable head stows below.
4. Optional walk-through windshield with concealed ladder makes deck access easy.

195 FREEDOM



"We finally stopped talking about it and bought a boat. What fun! Every day is a new adventure. We divide our time equally between snorkeling and fishing... You learn quickly out here to stow gear (boat speak for 'pick up your junk')... Everything has its place. I'm just having a hard time convincing 'Captain Bligh' that my place is at the helm - at least part of the time."

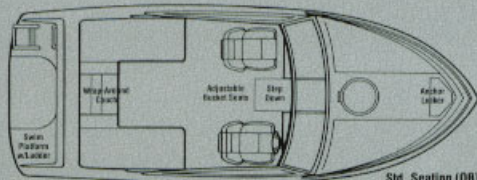

Std. Seating (08)

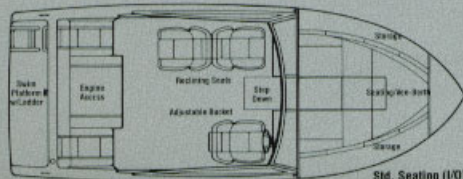

Std. Seating (10)/Cabin Int.



7

Four Winns Extra Value Standard Features

- Anchor locker w/molded anchor well
- Automatic bilge pump
- Balsa core reinforced deck and hull
- Cleats, rails, ski-eye... through-bolted, metal-backed
- Deep cycle, high cranking marine battery w/retainer
- Easy maintenance gel coated bilge
- Emergency engine shut-off
- Engine compartment sound insulation (I/O)
- Ergonomically-designed helm for maximum convenience, comfort and safety



5. Available with 120 HP or 150 HP of Johnson® or Evinrude® outboard power.
6. Bow anchor and line storage with molded anchor well.
7. Read-at-a-glance, sporty instrumentation.



6

5



A CUDDY THAT MEETS YOUR BUDGET...AND YOUR STANDARDS.

Only Four Winns could pack so many features and comforts into a cuddy this size – in this price range. Facing cabin seats convert to a comfortable, roomy berth for two. There's outstanding storage space under the cockpit floor, in the sidewalls, and beneath cabin seats. An optional concealed ladder system and walk-through windshield make deck access more convenient. Plus *Winning Edge™* 5/3/1 Owner Protection.

Specifications

LDA/Transom to Bow	19'8"/18'3" (VO) 20'1" (OB)
Beam	7'3"
Fuel (gal.)	32
Max. Cruise Range (mi.)*	120
Passengers	(VO) 8 (OB) 7
Maximum Capacity (lbs.)	(VO) 1300 (OB) 1640
Bridge Clearance	4'7"
Cockpit Depth (height)	35"
Draft (drive down)	30"
Trailer Weight, Empty (lbs.)	620

*Estimate. Actual Cruise Range may vary.

Power Ratings & Weights

Model	Crankshaft HP	Propshaft HP	Stair & Engine Weights
120 TX/V-4 (OB)	N/A	120 HP	2560
150 TX/EX/V-6 (OB)	N/A	150 HP	2600
3.0L-HD / L-4 (VO)	150 HP	130 HP	2620
4.3L/V-6 (VO)	175 HP	150 HP	2740

N/A: Not applicable

Model Availability

195 Outboard, 195 Stern Drive

Exclusive Winning Edge™ 5/3/1 Owner Protection Plan™: 5-year hull structural...3-year whole boat protection...1-year theft/liability coverage!

Four Winns Sure Load™ Trailer, single axle, custom bunk, color-coordinated, w/detachable tongue

Fuel tank, in-floor accessible
Fall width & depth plywood transom
Hand lay-up woven fiberglass w/coremat reinforcement at the bulkheads
Integrated, insulated cooler with overboard drain
Interlocking floor system w/tive stringer reinforcement

- Maximum closed cell foam added for rigidity, sound deadening, and level flotation
- National Marine Manufacturers Association certification
- Premium gel coat w/superior buff back characteristics
- Premium marine carpet w/superior drying properties, durability, fade and mat resistance
- Premium marine vinyl made to Four Winns specifications
- Quick-access hinged engine compartment lid (VO)
- Shrink wrap shipping
- Streamline sidewall design for maximum cockpit space
- Smooth-riding, fast-planing deep-vee hull

- Stainless, deep access 3-step swim ladder
- Ultraviolet-resistant, self-storing canvas convertible top
- Wood backing at all through-the-hull-and-deck fastening points

- Bilge blower (VO)
- Color-coded wiring
- Drain plug, brass
- Fused switches
- Instrumentation: (VO) fuel, oil pres., trim ind., water temp., speedometer, tachometer, voltmeter, (OB) tachometer, speedometer, fuel, voltmeter, trim ind.

Additional Standard Features

Exterior and Trim

- Cleats (4)
- Deck hatch, round
- Horn
- Navigation lights
- Swim platform, fiberglass integrated w/stainless ladder
- Windshield, tempered, bent glass

Functional and Convenience

- Power steering (VO)
- Power trim & tilt (OB)
- Power trim, tilt, & VRO™ (OB)
- Prop: single, aluminum
- Steering wheel, soft-foam

- Seating: cabin, back-to-back seats (fold to lounger), adjustable driver's seat, jump seats remove or make sun deck (VO), wrap-around stern lounge (OB)
- Stereo AM/FM cassette in weather resistant box

Interior

- Beverage holders, oversized (cockpit)
- Courtesy lights (cockpit)
- Dinette table, free standing
- Passenger console w/lockable glove box, integrated/insulated cooler w/overboard drain
- Sleeping for 2, vee-berth
- Storage: bow area, sidewall, concealed top (VO)
- Windows, port light

Major Options

- Custom-fit canvas motorcover
- Fall canvas package
- Head, portable
- Walk-through windshield w/ladder

*Ask your Four Winns dealer for full details. Coverage may be limited to \$33,000 (depending on plan) for the insured vessel.



1

1. Passenger console with integrated, insulated ice chest, locking glove box.
2. Flip-up engine cover for easy access.
3. Bow anchor, line storage with molded anchor well.

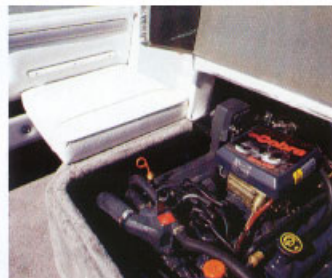

2



3

180 HORIZON



"Your brothers and I caught 'old Ironjaw,' son. The three of us were drifting off the point... just outside the reeds. The kid had just put a fat, juicy wriggler on his hook...and wham! Took all three of us to get him in the boat. For the record, he weighed in at 9½ pounds. You're going to have to take our word on this one, boy... 'cause we put him back..."

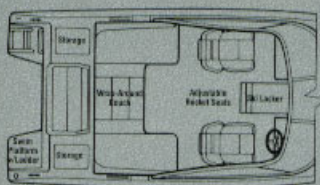

Opt. Seating (OB)

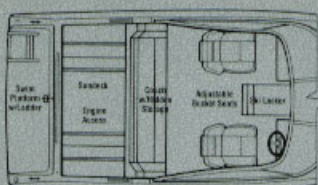

Brougham (I/O)

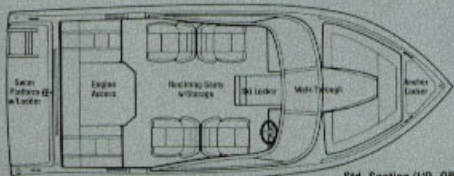

Std. Seating (I/O, OB)

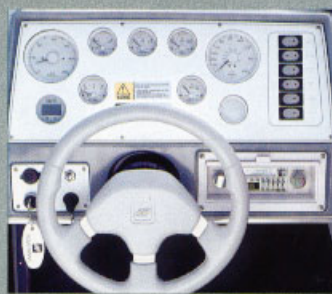

6

Four Winns Extra Value Standard Features

- Anchor locker w/molded anchor well
- Deep cycle, high cranking marine battery w/retainer
- Easy maintenance gel coated bilge
- Emergency engine shut-off
- Engine compartment sound insulation (I/O)
- Ergonomically-designed helm for maximum convenience, comfort and safety
- Exclusive Winning Edge™ 5/3/1 Owner Protection Plan™: 5-year hull structural...3-year whole boat protection...



- 4. 180 Horizon (Brougham seating) powered by OMC Cobra™ stern drive.
- 5. Deep-reaching, 3-step stainless ladder extends easily.
- 6. Full instrumentation, easy-reading gauges, and reliable rocker switches make the 180 dash exceptional.



5

4



THE DIFFERENCE BETWEEN ORDINARY SPORTBOATS AND THE EXTRAORDINARY 180 HORIZON.

Extras set Horizon™ sportboats apart...extra room, extra value, and extra features...the convenience of a weather-protected AM/FM stereo cassette... power steering, trim and tilt...stylish, wrap-around windshield...easy access engine cover...bow anchor locker...integrated self-draining cooler...Four Winns color-matched, custom-bunk Sure Load™ trailer. Extraordinary!

Specifications	
LOA/Transom to Bow:	18'6"/17'1"
Beam:	7'3"
Fuel (gal.):	32
Max. Cruise Range (mi.):*	140
Passengers:	8
Maximum Capacity (lbs.):	1040 (VO); 1650 (OB)
Bridge Clearance:	3'6"
Cockpit Depth (helm):	29"
Draft (drive down):	31"
Trailer Weight, empty (lbs.):	620

*Estimate. Actual Cruise Range may vary.

Power Ratings & Weights			
Model	Crankshaft HP	Propshaft HP	Boat & Engine Weights
120 TX/EX/V-4(OB)	N/A	120 HP	2043
150 TX/EX/V-6(OB)	N/A	150 HP	2060
3.0L-HO/V-4 (VO)	150 HP	130 HP	2420
4.3L/V-6 (VO)	175 HP	150 HP	2550
5.0L-HO/V-8 (VO)	200 HP	175 HP	2650

N/A: Not applicable.

Model Availability	
180 Outboard, 180 Outboard/Convertible, 180 Stern Drive,	
180 Stern Drive/Convertible	

1-year theft/accidental damage/liability coverage*
 Four Winns Sure Load™ Trailer, single axle, custom bunk, color-coordinated, w/detachable tongue
 Fuel tank, aluminum, in-floor, accessible
 Full width & depth plywood transom
 Hand lay-up woven fiberglass w/coremat reinforcement at the bulkheads
 Interlocking floor system w/five stringer reinforcement
 Maximum closed cell foam added for rigidity, sound deadening, and level flotation
 National Marine Manufacturers Association certification

- Premium gel coat w/superior buff back characteristics
- Premium marine carpet w/superior drying properties, durability, fade and mat resistance
- Premium marine vinyl made to Four Winns specifications
- Quick-access hinged engine compartment lid (I/O)
- Shrink wrap shipping
- Slimline sidewall design for maximum cockpit space
- Smooth-riding, fast-planing deep-vee hull
- Stainless rails, cleats, ski eye...through-bolted, metal-backed

- Stainless, deep access 3-step swim ladder
 - Ultraviolet-resistant, self-storing canvas convertible top
 - Wood backing at all through-the-hull-and-deck fastening points
- Additional Standard Features**
- Exterior and Trim
- Bow/stair rails, stainless
 - Cleats (4) stainless
 - Horn, flush mounted
 - Navigation lights
 - Step pads, non skid
 - Swim platform, fiberglass, integrated w/ladder
 - Windshield, tempered, curved glass, w/walk through

- Functional and Convenience
- Bilge blower (I/O)
 - Bilge pump
 - Color-coded wiring
 - Fused switches
 - Instrumentation: (I/O) fuel oil pres., trim ind., water temp., speedometer, tachometer, voltmeter, (OB) tachometer: speedometer, fuel, voltmeter, trim ind.
 - Power steering
 - Power trim & tilt (I/O)
 - Power trim, tilt & VR0™ (OB)
 - Prop: aluminum
 - Steering wheel, soft-heel, integrated w/ladder
 - Stereo AM/FM cassette (in weather-resistant box), w/ 2 speakers

- Interior
- Beverage holders, oversized (cockpit)
 - Passenger console w/lockable glove box and integrated, insulated ice chest
 - Seating: adjustable driver's seat, hinged bow seats (except convertible), back-to-back seats (folds-to-lounger), jump seats remove or make sundeck (I/O)
 - Ski locker w/lock-trimmed lid
 - Storage: bow area, sidewall, floor (ski), adjacent to engine mount (OB), concealed top (I/O)

- Major Options
- Auto. bilge pump switch
 - Brougham package
 - Cockpit galley
 - Convenience group
 - Depth sounder
 - Fiberglass floor liner w/ hinged fiberglass engine access, seat boxes
 - Fill-in cushions
 - Full canvas package
 - Halon automatic fire extinguishing system
 - Portable head w/privacy curtain (convertible only)
 - Stereo upgrade w/weather-band, graphic equalizer
 - SLX package
 - Swim platform, teak insert (I/O)
 - Tri-tone gel coat
 - Wrap-around stern couch (OB)

* Ask your Four Winns dealer for full details. Coverage may be obtained for a \$10 processing fee up to the insurance broker.

9



1



2



3



4

1. Convenient top storage compartment.
2. Optional premium sound system.
3. Optional bow fill-in cushions.
4. In-floor, teak-accented ski storage compartment.

200 HORIZON



"Attention family and friends...

For responsible water skiing,
please follow these rules:

1. Skier must wear flotation vest.
2. 'Spotter' in boat while skiing.
3. Ski in calm waters, clear of swimmers...other boaters.
4. Go to downed skier immediately.
5. Keep downed skier to starboard, in sight.
6. Shut off engine before pick up.

Thank you...Enjoy!"

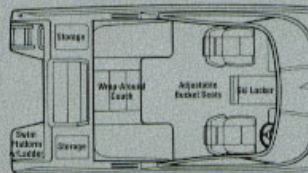

Opt. Seating (DB)

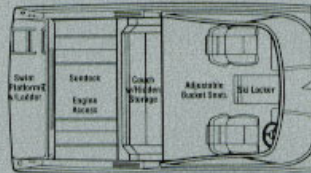

Brougham (I/O)

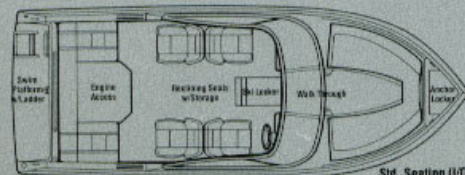

Std. Seating (I/O, DB)

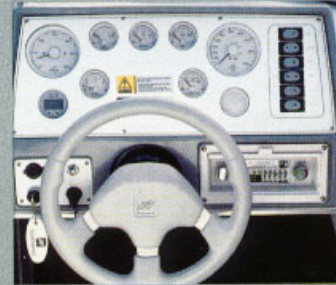

7

Four Winns Extra Value Standard Features

- Anchor locker w/molded anchor well
- Deep cycle, high cranking marine battery w/retainer
- Easy maintenance gel coated bilge
- Emergency engine shut-off
- Engine compartment sound insulation
- Ergonomically-designed helm for maximum convenience, comfort and safety
- Exclusive *Winning Edge*™ 5/3/1 Owner Protection Plan*: 5-year hull structural...3-year whole boat protection...1-year theft/accidental



5. Convertible model with standard color-matched Four Winns Sure Load™ trailer.
6. Digital depth sounder (optional).
7. Complete instrumentation monitors engine performance.



6



THERE'S ONLY ONE 20' SPORTBOAT GOOD ENOUGH TO BE CALLED HORIZON.

The hallmark of a Horizon™ sportboat is its impressive list of features...the ergonomically-designed helm... premium gel coat, vinyl, and carpet...smooth-riding, quick-planing deep vee hull...sleek, wrap-around windshield...passenger-side, integrated cooler and locking glove box...integrated bow anchor storage...self-storing canvas top...and more. The beauty and value of a Four Winns 200 Horizon sportboat runs deep.

Specifications

LOA/Transom to Bow:	20'9"/19'4"
Beam:	7'6"
Fuel (gal.):	44
Max. Cruise Range (mi.):*	160
Passengers:	10
Maximum Capacity (lbs.):	(1/0) 1510 (08) 2270
Bridge Clearance:	3'11"
Cockpit Depth (helm):	33 1/2"
Draft (drive down):	34"
Trailer Weight, Empty (lbs.):	Single 980 Tandem 1070

* Estimate. Actual Cruise Range may vary.

Power Ratings & Weights

Model	Crankshaft HP	Propshaft HP	Boat & Engine Weights
150 TX/EX/V-6 (08)	N/A	150 HP	2470
175 TX/EX/V-6 (08)	N/A	175 HP	2450
4.3L / V-6 (1/0)	175 HP	150 HP	2870
5.0L-HO / V-8 (1/0)	200 HP	175 HP	2970
5.8L / V-8 (1/0)	235 HP	210 HP	3040
5.7L / V-8 (1/0)	260 HP	220 HP	2970
5.7L-LE / V-8 (1/0)	260 HP	220 HP	3060
3500CI / V-8 (1/0)	270 HP	235 HP	3060

N/A: Not applicable.

Model Availability

200 Outboard, 200 Stern Drive, 200 Stern Drive/Convertible

- damage/liability coverage!
- Four Winns Sure Load™ Trailer, single or tandem axle, custom bunk, color-coordinated, w/detachable tongue
- Fuel tank, aluminum, in-floor, accessible
- Full width & depth plywood transom
- Hand lay-up woven fiberglass w/coremat reinforcement at the bulkheads
- Interlocking floor system w/life stringer reinforcement
- Maximum closed cell foam added for rigidity, sound deadening, and level flotation
- National Marine Manufacturers Association certification

- Premium gel coat w/superior buff back characteristics
- Premium marine carpet w/superior drying properties, durability, fade and mat resistance
- Premium marine vinyl made to Four Winns specifications
- Quick-access hinged engine compartment lid (1/0)
- Shrink wrap shipping
- Slimline sidewall design for maximum cockpit space
- Smooth-riding, fast-planing deep-vee hull
- Stainless rails, cleats, ski eye...through-bolted, metal-backed
- Stainless, deep access 3-step swim ladder

- Ultraviolet-resistant, self-storing canvas convertible top
- Wood backing at all through-the-hull-and-deck fastening points

Additional Standard Features

- Exterior and Trim
- Bowstair rails, stainless
 - Cleats (4) stainless
 - Horn, flush-mounted
 - Navigation lights
 - Step pads, non-skid
 - Swim platform, fiberglass, integrated w/ladder
 - Windshield, tempered, curved glass, w/walk-through

Functional and Convenience

- Bilge blower (1/0)
- Bilge pump
- Color-cooled wiring
- Drain plug, brass
- Fused switches
- Instrumentation: (1/0) fuel, oil pres., trim ind., water temp., speedometer, tachometer, voltmeter; (08) tachometer, speedometer, fuel, voltmeter, trim ind.
- Power steering
- Power trim & lift (1/0)
- Power trim, tilt, & VRD™ (08)
- Prop: single, aluminum
- Steering wheel, soft-feel
- Stereo AM/FM cassette (in weather-resistant box, w/ 2 speakers)

Interior

- Beverage holders, oversized (cockpit)
- Passenger console w/lockable glove box and integrated, insulated ice chest
- Seating: adjustable driver's seat, hinged bow seats (except convertible), back-to-back seats (fold-to-lounger), jump seats remove or make sundeck (1/0)
- Ski locker w/teak-trimmed lid
- Storage: bow area, sidewall, floor (ski), concealed top (1/0)

Major Options

- Automatic bilge pump switch
- Brougham package
- Cockpit gallery
- Convenience group
- Depth sounder
- Fiberglass floor liner
- Full canvas package
- Halon automatic fire extinguishing system
- Portable head w/privacy curtain (convertible only)
- SLX package
- Stereo upgrade w/weatherband, graphic equalizer
- Swim platform, teak insert (1/0)
- Tri-tone gel coat
- Wrap-around stern couch (08)

* Ask your Four Winns dealer for full details. Downgrading to eliminate for a \$15,000 price may be subject to the insurance broker.

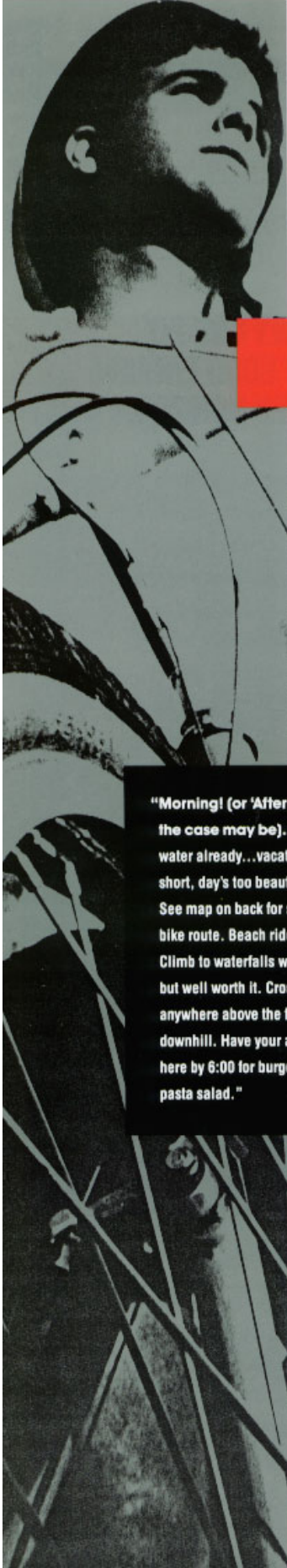

1



2

1. Integrated, insulated ice chest drains overboard.
2. Optional stereo AM/FM cassette w/ 60W equalizer.
3. Optional bow canopy adds privacy for optional portable head.
4. Large, sidewall storage compartments.



3



4

220 HORIZON



"Morning! (or 'Afternoon', as the case may be). We're on the water already...vacation's too short, day's too beautiful, etc., etc. See map on back for suggested bike route. Beach ride will be easy. Climb to waterfalls will be painful but well worth it. Cross the river anywhere above the falls...then it's downhill. Have your appetites back here by 6:00 for burgers, dogs and pasta salad."

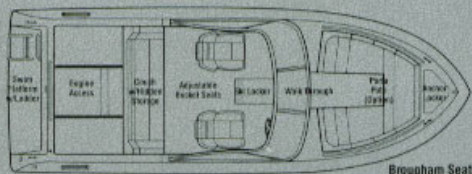

Brougham Seating

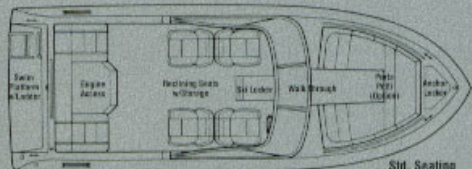

Std. Seating



7

- Four Winns Extra Value Standard Features**
- Anchor locker w/molded anchor well
 - Deep cycle, high cranking marine battery w/retainer
 - Easy maintenance gel coated bilge
 - Emergency engine shut-off
 - Engine compartment sound insulation
 - Ergonomically-designed helm for maximum convenience, comfort and safety
 - Exclusive *Winning Edge*™ 5/3/1 Owner Protection Plan™: 5-year hull structural, 3-year whole boat protection...



5

- 5. Power options up to 454 cu. in. OMC Cobra® stern drive. Brougham cockpit offers sun lounge and couch.
- 6. In-floor ski locker secures gear.
- 7. Smartly arrayed instruments let you command optimum performance.



6



YOU CAN PAY MORE, BUT YOU CAN'T BUY MORE SPORTBOAT.

The best thing to happen to sportboats since the 180 and 200 Horizon™...the 220 Horizon. Well-appointed and styled with contemporary flair, the 220 is engineered for large or small waterways...it's spacious, deep, and accommodating...and it's extra-versatile when equipped with an optional bow canopy to shelter people or gear from sun, rain, or wind.

Specifications

LOA/Transom to Bow:	23' 3"/21' 8"
Beam:	8' 4"
Fuel (gal.):	65
Max. Cruise Range (mi.):*	190
Passengers:	10
Maximum Capacity (lbs.):	2410
Bridge Clearance:	4' 6"
Cockpit Depth (helm):	34"
Draft (drive down):	33"
Trailer Weight, Empty (lbs.):	1200

*Estimate. Actual Cruise Range may vary.

Power Ratings & Weights

Model	Crankshaft HP	Propshaft HP	Boat & Engine Weights
5.0L / V-8	200 HP	175 HP	3510
5.8L / V-8	235 HP	210 HP	3560
5.7L / V-8	260 HP	220 HP	3510
5.7L-LE / V-8	260 HP	220 HP	3610
350CI / V-6	270 HP	235 HP	3610
454CI / V-8	330 HP	275 HP	3760

- 1-year theft/accidental damage/liability coverage*
- Four Winns Sure Load™ Trailer, tandem axle, custom bunk, color-coordinated, w/detachable tongue
- Fuel tank, aluminum, in-floor, accessible
- Full width & depth plywood transom
- Hand lay-up woven fiberglass w/coremat reinforcement at the bulkheads
- Interlocking floor system w/five stringer reinforcement
- Maximum closed cell foam added for rigidity, sound deadening, and level flotation
- National Marine Manufacturers Association certification

- Premium gel coat w/superior buff back characteristics
- Premium marine carpet w/superior drying properties, durability, fade and mat resistance
- Premium marine vinyl made to Four Winns specifications
- Quick-access hinged engine compartment lid
- Shrink wrap shipping
- Slimline sidewall design for maximum cockpit space
- Smooth-riding, fast-planing deep-vee hull
- Stainless rails, cleats, ski eye...through-bolted, metal-backed

- Stainless, deep 3-step swim ladder
- Ultraviolet-resistant, self-storing canvas convertible top
- Wood backing at all through-the-hull-and-deck fastening points

Additional Standard Features

- Exterior and Trim
- Bow/lift rails, stainless
 - Cleats (4) stainless
 - Horn, flush-mounted
 - Navigation lights
 - Swim platform, fiberglass, integrated w/ladder

- Windshield, tempered, curved glass, w/walk-through

Functional and Convenience

- Bilge blower
- Bilge pump
- Color-coded wiring
- Fused switches
- Instrumentation: fuel, oil pres., trim ind., water temp., speedometer, tachometer, voltmeter
- Power steering
- Power trim & tilt
- Steering wheel, soft-feel
- Stereo AM/FM cassette (in weather-resistant box), w/2 speakers

Interior

- Beverage holders, oversized (cockpit)
- Passenger console w/lockable glove box and integrated, insulated ice chest
- Seating: adjustable driver's seat, back-to-back seats (fold to lounger), jump seats remove or make sundeck
- Ski locker w/weak-trimmed lid
- Storage: bow area, sidewall, floor (ski), concealed top

Major Options

- Automatic bilge pump switch
- Bow canopy
- Brougham package
- Camper canvas
- Cockpit galley
- Convenience group
- Depth sounder
- Full canvas package
- Halon automatic fire extinguishing system
- Plexiglass walk-through door
- Portable head
- SLX package
- Stereo upgrade w/weather-band, graphic equalizer
- Swim platform, leak insert
- Tri-tone gel coat

*Ask your Four Winns dealer for full details. Coverage may be restricted for a \$35 processing fee paid to the insurance broker.



1



2

1. Color-matched bimini top is included with SLX package.
2. Hinged seat cushion lifts for access to storage.
3. Optional bow fill-in cushions.
4. Digital depth sounder.
5. The spirited 180 is available with up to 150 HP of Evinrude® or Johnson® outboard, or



3



4

180/200 CANDIA



"Well, how did you enjoy life on the water?...Sunburn better?...Enclosed is a video of your award winning slalom technique. Footage of the 'Venetian festival' and 'Miss Wild Asparagus' competition are in the camcorder...I'll finish the 'epic' at the offshore powerboat races next weekend. Bring some fresh tapes when you come back for the family reunion."

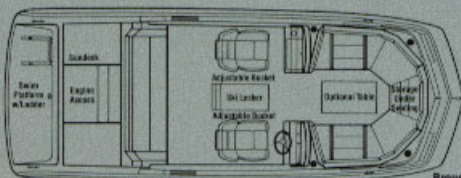

Brougham (I/O)

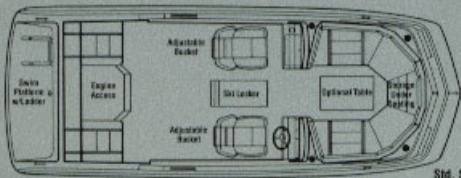

Std. Seating

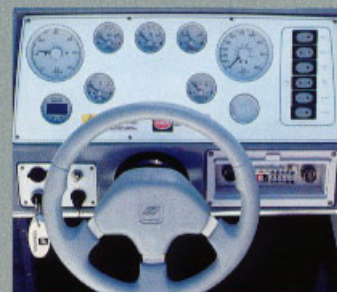

Four Winns Extra Value Standard Features

- Deep cycle, high cranking marine battery w/retainer
- Easy maintenance gel coated bilge
- Emergency engine shut-off
- Engine compartment sound insulation (I/O)
- Ergonomically-designed helm for maximum convenience, comfort and safety
- Exclusive *Winning Edge™* 5/3/1 Owner Protection Plan*: 5-year hull structural... 3-year whole boat protection... 1-year theft/accidental



5

- 5. 5.0L-HD V-8 OMC Cobra™ stern drive power...and accommodates up to 10 passengers.
- 6. Convenient ski storage in floor.
- 7. The Candia command center puts performance within easy sight and reach.



8



damage/liability coverage¹
Four Winns Sure Load™
 Trailer, single or tandem axle, custom bunk, color-coordinated, wide-detachable tongue
 Fuel tank, aluminum, in-floor, accessible
 Full width & depth plywood transom
 Hand lay-up woven fiberglass w/coremat reinforcement at the bulkheads
 Interlocking floor system w/five stringer reinforcement
 Maximum closed cell foam added for rigidity, sound deadening, and level flotation
 National Marine Manufacturers Association certification

- Premium gel coat w/superior buff back characteristics
- Ultraviolet-resistant, self-storing canvas convertible top
- Wood backing at all through-the-hull-and-deck fastening points
- Premium marine vinyl made to Four Winns specifications
- Quick-access hinged engine compartment lid (I/O)
- Shrink wrap shipping
- Slimline sidewall design for maximum cockpit space
- Smooth-riding, fast-planing step pad hull
- Stainless rails, cleats, ski eye...through-bolted, metal-backed

- Stainless, deep access 3-step swim ladder
- Ultraviolet-resistant, self-storing canvas convertible top
- Wood backing at all through-the-hull-and-deck fastening points

Additional Standard Features

- Exterior and Trim
- Cleats (4) stainless
- Horn, flush mounted
- Navigation lights
- Step pads, non-skid
- Swim platform, fiberglass, integrated w/stainless ladder
- Venturi windshield

Functional and Convenience

- Bilge blower (I/O)
- Bilge pump
- Color-coded wiring
- Drain plug, brass
- Fused switches
- Instrumentation: (I/O) fuel, oil pres., trim ind., water temp., speedometer, tachometer, voltmeter, (O/B) speedometer, tachometer, fuel, voltmeter, trim ind.
- Power steering (I/O)
- Power trim & tilt (I/O)
- Power trim, tilt & VRO™ (O/B)
- Prop: single, aluminum
- Steering wheel, soft-feel

- Stereo AM/FM cassette (in weather-resistant box), w/weatherband and 2 speakers

Interior

- Beverage holders, oversized (cockpit)
- Courtesy lights
- Passenger console w/lockable glove box and integrated, insulated ice chest
- Seating: adjustable bucket seats, U-shaped bow seat, jump seats remove or make sundeck (I/O)
- Storage: bow area, sidewall, in-floor (ski), concealed top (I/O)
- Ski locker w/teak trimmed lid

Major Options

- Automatic bilge pump switch
- Brougham package
- Console windscreen
- Convenience group
- Depth sounder
- Halon automatic fire extinguishing system
- Mooring cover
- SLX package
- Stereo upgrade w/weather-band, graphic equalizer
- Swim platform, teak insert
- Table
- Tri-tone gel coat

¹ Ask your Four Winns dealer for full details.
² Coverage may be obtained for a \$10 processing fee paid to the insurance broker.

YOU'LL BE THRILLED WITH THE ROOM. BUT THE THRILLS WON'T STOP THERE.

Like most deck boats, 180 and 200 Candia™ deck boats feature a broad, stable platform to accommodate an amazing number of guests. Candia models pack amazing performance, as well. And, in keeping with Four Winns value philosophy, Candia deck boats come complete with an impressive list of features...an insulated, integrated cooler, in-floor ski locker... incredible storage capacity...optional bow fill-in cushions and table.

Specifications	180	200
LOA/Transom to Bow:	19'8"/18'1"	21'7"/20'
Beam:	7'8"	8'
Fuel (gal.):	32	32
Max. Cruise Range (mi.):*	125	110
Passengers:	10	13
Maximum Capacity (lbs.):	(I/O) 1600 (O/B) 2200	1805
Bridge Clearance:	3'9"	3'9"
Cockpit Depth (helm):	31"	31"
Draft (drive down):	26"	26"
Trailer Weight, Empty (lbs.):	940	1150

*Estimate. Actual Cruise Range may vary.

Power Ratings & Weights	180	200		
Model	Crankshaft HP	Propshaft HP	Bow & Engine Weights	Full & Engine Weights
120 TX/V-4 (O/B)	N/A	120 HP	2390	-
150 TX/EX/V-6 (O/B)	N/A	150 HP	2410	-
3.0L-HD/V-4 (I/O)	150 HP	130 HP	2800	-
4.3L/V-6 (I/O)	175 HP	150 HP	2930	2850
5.0L-HD/V-8 (I/O)	200 HP	175 HP	3030	2950
5.8L/V-8 (I/O)	235 HP	210 HP	-	3310
5.7L/V-8 (I/O)	260 HP	220 HP	-	2950
5.7L-LE/V-8 (I/O)	260 HP	220 HP	-	3040
350CI/V-8 (I/O)	270 HP	235 HP	-	3040

N/A: Not applicable.

Model Availability

180 Outboard, 180 and 200 Stern Drives



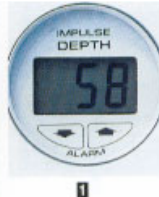

1



2

1. Digital depth sounder is standard.
2. Standard AM/FM stereo cassette.
3. Bright, designer-styled vee-birth sleeps two.
4. Split windshield option includes access ladder.



3



4

205 SUNDOWNER



"My dear parents... Thank you for passing your love of and respect for the water on to me... Thank you for all the good times afloat...funny, they mean so much more to me now than they did then...I chose our first boat on the values you taught me...It is, at once, our RV and our vacation home...I'll try to make it the same happy, idyllic retreat you provided for your family..."

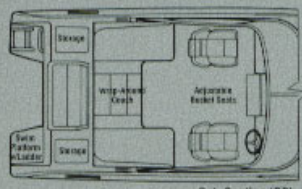

Opt. Seating (OB)

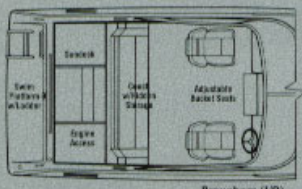

Brougham (I/O)

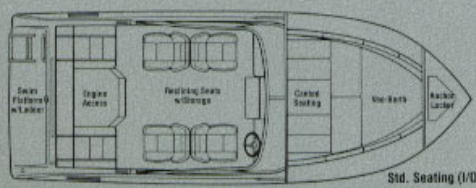

Std. Seating (I/O, OB)/Cabin Int.

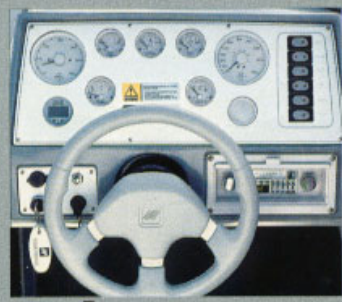

7

- Four Winns Extra Value Standard Features**
- Anchor locker w/molded anchor well
 - Automatic bilge pump
 - Balsa core reinforced deck
 - Deep cycle, high cranking marine battery w/retainer
 - Easy maintenance gel coated bilge
 - Emergency engine shut-off
 - Engine compartment sound insulation (I/O)
 - Ergonomically-designed helm for maximum convenience, comfort and safety
 - Exclusive *Winning Edge*™ 5/3/1 Owner Protection Plan*: 5-year hull structural, 3-year



5

- 5. The 205 Sundowner powered with dependable 150 or 175HP Johnson® or Evinrude® outboard.
- 6. Self-storing convertible canvas top is UV-treated.
- 7. Complete instrumentation includes trim indicator.



6



FOR PROOF THAT NO ONE KNOWS FAMILIES LIKE FOUR WINNS DOES, LOOK NO FURTHER THAN 205 SUNDOWNER.

A logical next step for runabout owners, the 205 Sundowner™ represents a new level of boating adventure. Like all Sundowner models, the 205 is filled with family-minded features...AM/FM stereo/cassette... padded steering wheel...adjustable driver's seat... oversized beverage holders...lockable cabin door... and comfortable vee-berth. Plus all the options you need to make Sundowner unique to your family.

Specifications

LOA/Transom to Bow:	20'9" / 19'4"
Beam:	7'8"
Fuel (gal.):	44
Max. Cruise Range (mi.):*	150
Passengers:	10
Maximum Capacity (lbs.):	(I/O) 1470 (OB) 2165
Bridge Clearance:	4'
Cockpit Depth (helm):	38"
Draft (drive down):	35"
Trailer Weight, Empty (lbs.):	1070

*Estimate. Actual Cruise Range may vary.

Power Ratings & Weights

Model	Crankshaft HP	Propshaft HP	Boat & Engine Weights
150 TX/EX/V-6 (OB)	N/A	150 HP	2730
175 TX/EX/V-6 (OB)	N/A	175 HP	2750
4.3L/V-6 (I/O)	175 HP	150 HP	3120
5.0L-HO/V-8 (I/O)	200 HP	175 HP	3220
5.8L/V-8 (I/O)	235 HP	210 HP	3290
5.7L/V-8 (I/O)	260 HP	220 HP	3220
5.7L-LE/V-8 (I/O)	260 HP	220 HP	3310
350CI/V-8 (I/O)	270 HP	235 HP	3310

N/A: Not applicable.

Model Availability

205 Outboard, 205 Stern Drive

- whole boat protection, 1-year theft/accidental damage/liability coverage¹
- Four Winns Sure Load™ trailer, tandem axle, custom bunk, color-coordinated, w/detachable tongue
- Fuel tank, aluminum, in-floor, accessible
- Full width & depth plywood transom
- Hand lay-up woven fiberglass w/coremat reinforcement at the bulkheads
- Interlocking floor system w/ive stringer reinforcement
- Maximum closed cell foam added for rigidity, sound deadening, and level flotation
- National Marine Manufacturers Association

- Premium gel coat w/superior buff back characteristics
- Premium marine carpet w/superior drying properties, durability, fade and mat resistance
- Premium marine vinyl made to Four Winns specifications
- Quick-access hinged engine compartment lid (I/O)
- Shrink wrap shipping
- Slimline sidewall design for maximum cockpit space
- Smooth-riding, fast-planing deep-vee hull
- Stainless rails, cleats, ski eye...through-bolted, metal-backed

- Stainless, deep access 3-step swim ladder
 - Ultraviolet-resistant, self-storing canvas convertible top
 - Wood backing at all through-the-hull-and-deck fastening points
- Additional Standard Features**
- Exterior and Trim
- Bow/stair rails, stainless
 - Cleats (4) stainless
 - Deck hatch, round
 - Horn, flush-mounted
 - Navigation lights
 - Port lights (2)
 - Step pads, non-skid
 - Swim platform, fiberglass, integrated w/stainless ladder

- Walk-through fiberglass transom door
 - Windshield, tempered, curved glass
- Functional and Convenience
- Bilge blower (I/O)
 - Color-coded wiring
 - Drain plug, brass
 - Fused switches
 - Instrumentation: (I/O) fuel, oil pres., trim ind., water temp., speedometer, tachometer, voltmeter, (OB) speedometer, tachometer, fuel, voltmeter trim ind.
 - Power steering (I/O)
 - Power trim & lift (I/O)
 - Power trim, lift & VRO™ (OB)

- Steering wheel, soft-feel
 - Stereo AM/FM cassette (in weather-resistant box), w/ 4 speakers
 - Transom light
- Interior
- Beverage holders, oversized (cockpit)
 - Cabin light
 - Cabin door w/lock, plexiglass
 - Passenger console w/lockable glove box and integrated, insulated ice chest
 - Seating: cabin, adjustable driver's seat, back-to-back seats (fold to lounger), jump seats remove or make sundeck (I/O)
 - Sleeping for 2, vee-berth
 - Storage: bow area, sidewall, coalesced top (I/O), adjacent to engine mount (OB)

Major Options

- Brougham package
- Cockpit galley
- Convenience group
- Depth sounder
- Full canvas package
- Halon automatic fire extinguishing system
- Portable head
- SLX package
- Stereo upgrade w/weather-band, graphic equalizer
- Swim platform, teak insert (I/O)
- Tri-tone gel coat
- Walk-through windshield w/deck access ladder
- Wrap-around stern couch (OB)

¹ Ask your Four Winns dealer for full details. Coverage may be continued for a \$15 insuring fee paid to the insurance broker.

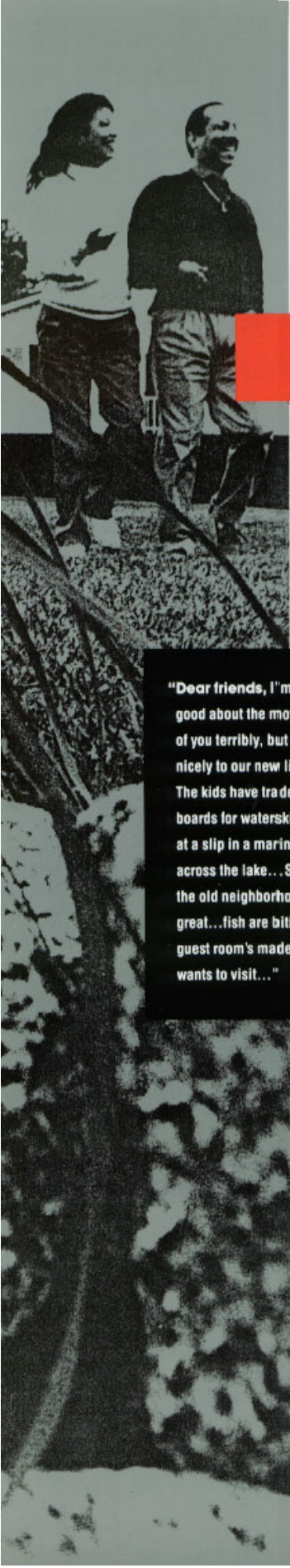

1

1. Storage compartment above engine and innovative, walk-through transom accessway. (Brougham)
2. Spacious vee-berth sleeps two comfortably.
3. Optional seating becomes L-shaped with cockpit galley option.



2



3

225 SUNDOWNER

"Dear friends, I'm finally feeling good about the move... Miss all of you terribly, but we're adjusting nicely to our new life on the water. The kids have traded their skateboards for waterskis... and I 'park' at a slip in a marina when I shop across the lake... Say hello to all in the old neighborhood. Weather's great... fish are biting... and the guest room's made up if anyone wants to visit..."

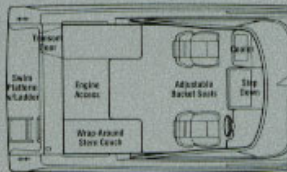

Opt. Seating

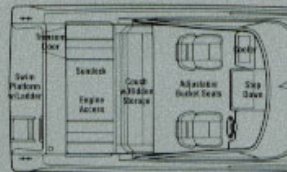

Brougham

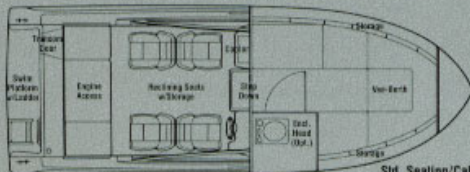

Std. Seating/Cabin Int.



6

- Four Winns Extra Value Standard Features**
- Anchor locker w/molded anchor well
 - Automatic bilge pump
 - Balsa core reinforced deck
 - Deep cycle, high cranking marine battery w/retainer
 - Easy maintenance gel coated bilge
 - Emergency engine shut-off
 - Engine compartment sound insulation
 - Ergonomically-designed helm for maximum convenience, comfort and safety
 - Exclusive *Winning Edge™* 5/3/1 Owner Protection Plan*: 5-year hull structural, 3-year whole



4. 225 Sundowner, available with up to 460 cu. in. OMC Cobra® stern drive.
5. Integrated, insulated cooler with overboard drain.
6. Ergonomically-designed helm station with back-lit instrumentation, lighted rocker switches and soft-feel steering wheel.



AFTER THE SUN SETS, SHE REALLY STARTS TO SHINE.

All the best things about boating...and the best things we know about building them...have gone into the 225 Sundowner™ cuddy. A deep cockpit, for a high and dry ride. A stable 8'4" beam, for space throughout. A cozy, space-efficient cabin, ideal for overnight excursions...bow anchor locker, transom entry door, and optional enclosed portable head.

Specifications

LQA/Transom to Bow:	23'3" / 21'8"
Beam:	8'4"
Fuel (gal.):	65
Max. Cruise Range (mi.):*	175
Passengers:	10
Maximum Capacity (lbs.):	2410
Bridge Clearance:	5'3"
Cockpit Depth (helm):	40"
Draft (drive down):	35"
Trailer Weight, Empty (lbs.):*	1200

*Estimate. Actual Cruise Range may vary.

Power Ratings & Weights

Model	Crankshaft HP	Propshaft HP	Boat & Engine Weights
5.0L-H0/V-8	200 HP	175 HP	4020
5.8L/V-8	235 HP	210 HP	4090
5.7L/V-8	260 HP	220 HP	4020
5.7L-LE/V-8	260 HP	220 HP	4120
350CI/V-8	270 HP	235 HP	4120
454CI/V-8	330 HP	275 HP	4270

- Boat protection, 7-year theft/accidental damage/liability coverage¹
- Four Winns Sure Load™ Trailer, tandem axle, custom bunk, color-coordinated, w/detachable tongue
- Fuel tank, aluminum, in-floor, accessible
- Full width & depth plywood transom
- Hand lay-up woven fiberglass w/coremat reinforcement at the bulkheads
- Interlocking floor system w/live stringer reinforcement
- Maximum closed cell foam added for rigidity, sound deadening, and level flotation
- National Marine Manufacturers Association certification

- Premium gel coat w/superior buff back characteristics
- Premium marine carpet w/superior drying properties, durability, fade and mat resistance
- Premium marine vinyl made to Four Winns specifications
- Quick-access hinged engine compartment lid
- Self-bailing fiberglass cockpit
- Shrink wrap shipping
- Slimline sidewall design for maximum cockpit space
- Smooth-riding, fast-planing deep-vee hull
- Stainless rails, cleats, ski eye...through-bolted, metal-backed

- Stainless, deep access 3-step swim ladder
 - Ultraviolet-resistant, self-storing canvas convertible top
 - Wood backing at all through-the-hull-and-deck fastening points
- Additional Standard Features**
- Exterior and Trim
- Bow/taft rails, stainless
 - Cleats (4) stainless
 - Deck hatch, round
 - Horn, flush-mounted
 - Navigation lights
 - Non-skid walk-around deck
 - Port lights (2)
 - Step pads, non-skid

- Swim platform, fiberglass, integrated w/stainless ladder
 - Transom light
 - Walk-through transom door
 - Windshield, tempered, curved glass
- Functional and Convenience
- Bilge blower (I/O)
 - Color-coded wiring
 - Fused switches
 - Instrumentation: fuel, oil, pres., trim ind., water temp., speedometer, tachometer, voltmeter
 - Power steering
 - Power trim & tilt
 - Steering wheel, soft-feel
 - Stereo AM/FM cassette (in weather-resistant box), w/4 speakers

Interior

- Beverage holders, oversized (cockpit)
- Cabin lights
- Cabin door w/lock, plexiglass
- Courtesy lights
- Head, portable
- Passenger console w/integrated, insulated ice chest
- Passenger grab rail
- Seating: adjustable driver's seat, back-to-back seats (folds to lounger), removable jump seats, vee-berth
- Sleeping for 2, vee-berth
- Storage: bow area, sidewall, concealed top
- Water storage (15 gal.)

Major Options

- Brougham package
- Cockpit galley
- Convenience group
- Depth sounder
- Full canvas package
- Halon automatic fire extinguishing system
- Head enclosure
- SLX package
- Stereo upgrade w/weather-band, graphic equalizer
- Swim platform, teak insert
- Tri-tone gel coat
- Walk-through fiberglass transom door
- Walk-through windshield w/deck access ladder
- Wrap-around stern couch (L-lounge with cockpit galley)

¹ Ask your Four Winns dealer for full details. Coverage may be continued for a \$15 processing fee paid to the insurance broker.



1



2



3

1. Cushioned vee-berth, fold-away dinette.
2. Galley with sink, ice box.
3. Fiberglass underside storage, engine compartment standard with fiberglass floor liner.
4. Available with OMC Cobra® power from single 5.8L/V-8

255 SUNDOWNER



"Dear Neighbors... As always, the sun, the air, and especially the water have rejuvenated us... Close call the other evening... had to rescue a boy adrift on a raft. Glad we were there! Glad our school offers boating safety!... Looking forward to your visit... Planning lots of fun water excitement for you..."

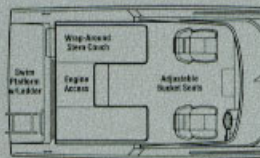

Opt. Seating

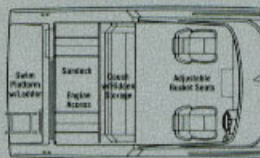

Brougham

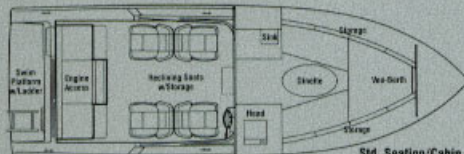

Std. Seating/Cabin Int.



4

Four Winns Extra Value Standard Features

- Anchor locker w/molded anchor well
- Automatic bilge pump
- Balsa core reinforced deck & hull
- Deep cycle, high cranking marine battery w/retainer
- Easy maintenance gel coated bilge
- Emergency engine shut-off
- Engine compartment sound insulation
- Ergonomically-designed helm for maximum convenience, comfort and safety
- Exclusive *Winning Edge™* 5/3/1 Owner Protection Plan*: 5-year hull



- to 5.0L-HO twins. Optional seating includes bucket seats, stern couch.
- Enclosed portable head and mirror.
 - Ergonomically-designed helm with lighted rocker switches and premium instrumentation.



5

4



BUILDING A BOAT LIKE THIS TAKES UNCOMMON KNOW-HOW. BUYING ONE SIMPLY TAKES COMMON SENSE.

Top of the line in affordable family cruising is the stylish, feature-packed 255 Sundowner™ cuddy. Spacious, yet trailerable. Equipped with the expected amenities...dinette, galley, enclosed head...100-gallon fuel capacity and reliable OMC Cobra® power. Plus pleasant surprises...a walk-through transom door... stereo AM/FM cassette... self-bailing fiberglass cockpit...and abundant storage space.

Specifications

LOA/Transom to Bow:	26'2"/24'7"
Beam:	8'6"
Fuel (gal.):	100
Max. Cruise Range (mi.):*	190
Passengers:	10
Maximum Capacity (lbs.):	Y
Bridge Clearance:	5'8"
Cockpit Depth (helm):	37"
Draft (drive(s) down):	38"
Trailer Weight, Empty (lbs.):	1760

* Estimate. Actual Cruise Range may vary.
Y = Yacht certified

Power Ratings & Weights

Model	Crankshaft HP	Propshaft HP	Boat & Engine Weights
5.8L / V-8	235 HP	210 HP	4860
5.7L-LE / V-8	260 HP	220 HP	4890
350 CI / V-8	270 HP	235 HP	4890
454 CI / V-8	330 HP	275 HP	5040
Twin 4.3L / V-6	175 EA	150 EA	5550
Twin 5.0L-HO	200 EA	175 EA	5750

structural, 3-year whole boat protection, 1-year theft/accidental damage/liability coverage*

Fuel tank, aluminum, in-floor, accessible. Full width & depth plywood transom. Hand lay-up woven fiberglass w/coremat reinforcement at the bulkheads. Interlocking floor system w/five stringer reinforcement. Maximum closed cell foam added for rigidity and sound deadening. National Marine Manufacturers Association certification. Premium gel coat w/superior buff back characteristics.

- Premium marine carpet w/superior drying properties, durability, fade and mat resistance
- Premium marine vinyl made to Four Winns specifications
- Quick-access hinged engine compartment lid
- Self-bailing fiberglass cockpit
- Shrink wrap shipping
- Slimline sidewall design for maximum cockpit space
- Smooth-riding, fast-planing deep-vee hull foam added for rigidity and sound deadening
- Stainless, deep access, 3-step swim ladder

• Ultraviolet-resistant, self-storing canvas convertible top

• Wood backing at all through-the-hull-and-deck fastening points

Additional Standard Features

Exterior and Trim

- Bow/lift rails, stainless
- Cleats (4) stainless
- Deck hatch, round
- Horn, flush mounted
- Navigation lights
- Port lights (2)
- Step pads, non-skid
- Swim platform, fiberglass, integrated w/stainless ladder
- Walk-through transom door

- Windshield, tempered, curved glass

Functional and Convenience

- Battery switch, dual**
- Bilge blower
- Bulkhead pass-through hatch
- Color-coded wiring
- Counter rotating props**
- Fused switches
- Instrumentation: fuel, oil pres., trim ind., water temp., speedometer, tachometer, voltmeter
- Power steering
- Power trim & tilt
- Props: single, aluminum; twins, stainless
- Steering wheel, soft-feel
- Stereo AM/FM cassette w/ 4 speakers

Interior

- Beverage holders, oversized (cockpit)
- Cabin lights
- Cabin door w/lock
- Courtesy lights (cockpit)
- Dinette table, free standing
- Galley w/ice box
- Head, portable, enclosed w/mirror
- Passenger grab rail
- Pillows (cabin decor)
- Recessed cabin lighting
- Seating, adjustable driver's seat, back-to-back seats (fold to lounger), jump seats remove or make sundeck
- Sink
- Sleeping for 2, vee-berth
- Storage: bow area, sidewall, concealed top
- Water storage (15 gal.)

Major Options

- Brougham package
- Cockpit galley
- Color-matched trailer
- Convenience group
- Depth sounder
- Full canvas package
- Halon automatic fire extinguishing system
- Premium AM/FM stereo cassette w/BOW equalizer, seek/scan, LED clock, 4 coaxial speakers, weatherband
- SLX package
- Swim platform, teak insert
- Tri-tone gel coat
- Trim tabs
- Wrap-around stern couch

* Ask your Four Winns dealer for full details.

** Win engines only.

† Coverage may be continued for a \$15 processing fee paid to the insurance broker.





1



2

1. Transom wash down and shower (optional)
2. Companion helm seat with rotating base (optional)
3. Functional galley with ice box, alcohol stove, stainless sink and storage

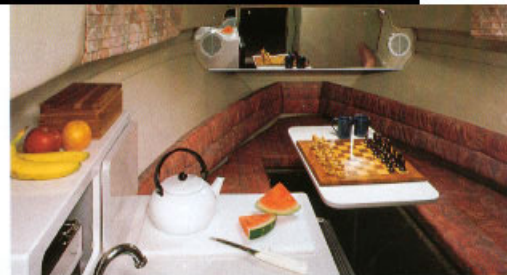

3

235 VISTA



"The area is called 'Thousand Islands,' sis. I'll say. Spent a week exploring and only stood on fifty of them. Every one different. Yesterday, up early. A game of chess, quick swim (read, bath), and we were on our way into a glorious sunrise. An absolutely incredible morning to end an equally incredible trip. Henry Hudson would have been proud. Have I got slides for you!..."

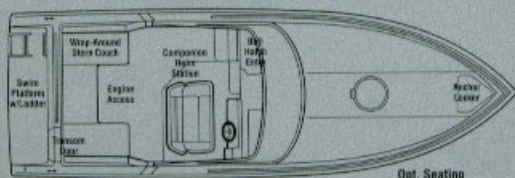

Opt. Seating

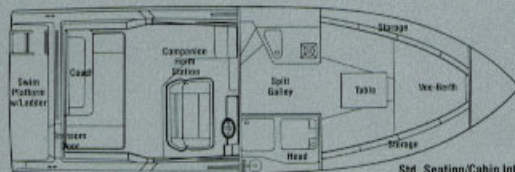

Std. Seating/Cabin Int.



7

Four Winns Extra Value Standard Features

- Anchor locker w/molded anchor well
- Automatic bilge pump
- Balsa core reinforced deck & hull
- Deep cycle, high cranking marine battery w/retainer
- Easy maintenance gel coated bilge
- Emergency engine shut-off
- Engine compartment sound insulation
- Ergonomically-designed helm for maximum convenience, comfort and safety
- Exclusive *Winning Edge*™ 5/3/1 Owner Protection Plan*: 5-year hull

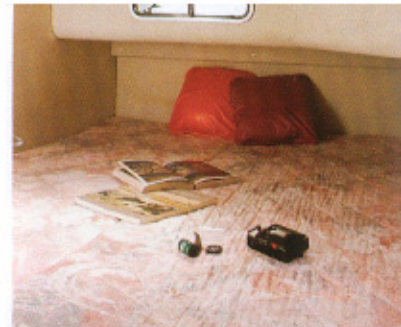

4. Mid-cabin features double berth with window.
5. Enclosed portable head with sink and shower.
6. Walk-through windshield with access step.
7. Wrap-around, multi-level, backlit instrumentation.



5



6



OVERNIGHT SUCCESS STORY.

The all-new Four Winns 235 Vista cruiser, premiering this year, has earned rave initial reviews. At 24'4" with an 8'6" beam, the 235 is a graceful young member of the liveaboard class. Forward and mid-cabins provide overnight accommodations for four, and the complete galley and enclosed head are efficient and accommodating. In the cockpit, there's a distinctive step-up dash with walk-through deck access, a double helm station seat, and stern passenger lounge.

Specifications

LOA/Transom to Bow:	24'4"/22'9"
Beam:	8'6"
Fuel (gal.):	75
Max. Cruise Range (mi.):*	120
Water (gal.):	15
Passengers:	10
Maximum Capacity (lbs.):	N/A
Bridge Clearance:	6'4"
Cockpit Depth (helm):	32"
Draft (drive(s) down):	36"
Trailer Weight, Empty (lbs.):	1620

*Estimate. Actual Cruise Range may vary.
N/A: Not available at time of printing.

Power Ratings & Weights

Model	Crankshaft HP	Propshaft HP	Boat & Engine Weights
5.8L / V-8	235 HP	210 HP	4800
5.7L-LE / V-8	260 HP	220 HP	4830
454CI / V-8	330 HP	275 HP	4980

structural, 3-year whole boat protection, 1-year theft/accidental damage/liability coverage!
Fuel tank, aluminum, in-floor, accessible
Full width & depth plywood transom
Hand lay-up woven fiberglass w/coremat reinforcement at the bulkheads
Interlocking floor system w/five stringer reinforcement
Maximum closed cell foam added for rigidity, sound deadening, and level flotation
National Marine Manufacturers Association certification
Premium gel coat w/superior buff back characteristics
Premium marine carpet

w/superior drying properties, durability, fade and mat resistance
• Premium marine vinyl made to Four Winns specifications
• Radio weatherband
• Shrink wrap shipping
• Slimline sidewall design for maximum cockpit space
• Smooth-riding, fast-planing deep-vee hull
• Stainless, deep access 3-step swim ladder
• Stainless rails, cleats... through-bolted, metal-backed
• Ultraviolet-resistant, self-storing canvas convertible top
• Wood backing at all through-the-hull-and-deck fastening points

Additional Standard Features

Exterior and Trim

- Bow/lift rails, stainless, welded
- Chrome vents
- Cleats (6) stainless
- Deck hatches (2), round
- Horn, flush mounted
- Navigation lights
- Non-skid walk-around deck
- Port lights (4)
- Swim platform, fiberglass, integrated w/ladder
- Walk-through fiberglass transom door
- Windshield, tempered, curved glass

Functional and Convenience

- Bilge blower
- Color-coded wiring
- Compass
- Drain plug, brass
- Fused switches
- Hour meter
- Instrumentation: fuel; oil pres.; trim ind.; water temp.; speedometer, tachometer, voltmeter
- Power steering
- Power trim & lift
- Prop: aluminum
- Steering wheel, soft-feel
- Stereo AM/FM cassette

Interior

- Bell hatch cabin entry, pivoting, single track, bi-fold doors, plexiglass
- Cabin lights

- Canvas top and cockpit cover, color-coordinated
- Courtesy lights
- Curtains mid-cabin, (privacy), windows
- Dinette table, expandable fold-away
- Fiberglass cockpit liner, self-bailing
- Galley: alcohol stove, ice box, sink, storage
- Head, portable enclosed
- Indirect lighting (cabin)
- Mid-cabin
- Mirror
- Pillows (cabin decor)
- Seating: companion helm, cabin
- Shower (pressurized)
- Sleeping for 4: vee-berth, mid-cabin
- Storage: bow area, sidewall
- Vanity & sink, enclosed
- Water inlet (dockside)
- Water storage (15 gal.)
- Windows: mid-cabin w/screens, side w/screens

Major Options

- Air conditioning
- Bow pulpit
- Color-matched trailer
- Convenience group
- Depth sounder
- Full canvas package
- Halon automatic fire extinguishing system
- Microwave oven
- Radar arch
- Refrigerator
- Stern couch
- Stereo remote control
- Stereo upgrade w/60W equalizer, seek/scan, w/4 coaxial speakers, LED clock
- Trim tabs, hydraulic
- Wrap-around stern lounge

* Ask your Four Winns dealer for full details.
† Coverage may be continued for a \$15 processing fee paid to the insurance broker.





1



2

1. Enclosed head, with sink and shower is standard.
2. Mid-cabin berth with window sleeps two.
3. Cabin amenities include all the liveaboard necessities.
4. Optional transom wash-down system with fresh water taps and shower attachment.



3



4

265 VISTA



"To: Twin Lakes Visitor's Bureau...
 Each season, our boat club picks a waterside destination for an adventurous excursion. Your area has been recommended. Please send information on dining, accommodations, marina services, ports of call, fishing, etc. Also include a calendar of local events, festivals, arts & crafts shows, antique boat shows, and other fun stuff. Have boats, will travel."

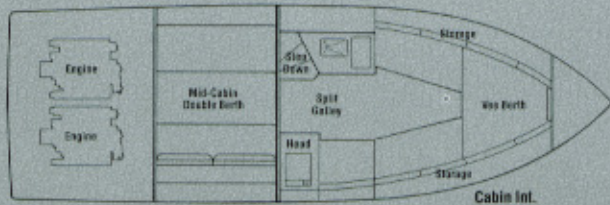
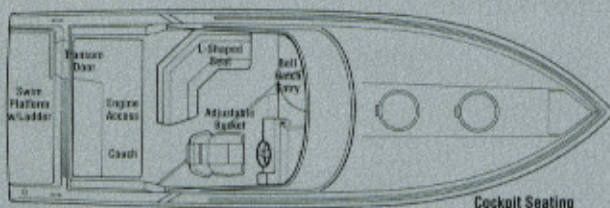

7

- Four Winns Extra Value Standard Features**
- Anchor locker w/molded anchor well
 - Automatic bilge pump
 - Balsa core reinforced deck & hull
 - Deep cycle, high cranking marine battery w/retainer
 - Easy maintenance gel coated bilge
 - Emergency engine shut-off
 - Engine compartment sound insulation
 - Ergonomically-designed helm for max. convenience, comfort and safety
 - Exclusive *Winning Edge*™ 5/3/1 Owner Protection Plan*: 5-year hull



5. Custom-bunk, color-matched Four Winns Sure Load™ trailer is optional.
6. Four Winns patented bell-hatch cabin entryway
7. Complete instrumentation positioned for ease of reading.



6



5

LIVEABLE LUXURY. A TRAILERABLE BEAM. UNFORGETTABLE ADVENTURES AHEAD.

Combining the comforts of a wide-body with a trailerable beam wasn't easy. But it was worthwhile. Presenting the Four Winns 265 Vista...below deck, a roomy cruiser – complete with galley, lounge seating that converts to dinette or spacious double berth, enclosed head/sink/shower, and mid-cabin double berth. In the cockpit, an adjustable helm bucket, L-shaped passenger lounge with optional rotating base. All that luxury. All still legally trailerable in all 50 states.



Specifications

LDA/Transom to Bow:	26'2" / 24'7"
Beam:	8'6"
Fuel (gal.):	85
Water (gal.):	20
Max. Cruise Range (mi.):*	140
Passengers:	10
Maximum Capacity (lbs.):	Y
Bridge Clearance:	6'8" (8'4" w/arch)
Cockpit Depth (helm):	27" / 37"
Draft (drive(s) down):	39"
Trailer Weight, Empty (lbs.):	1760

*Estimate. Actual Cruise Range may vary.
Y = Yacht certified.

Power Ratings & Weights

Model	Crankshaft HP	Propshaft HP	Boat & Engine Weights
5.7L-LE / V-8	260 HP	220 HP	5690
454CI / V-8	330 HP	275 HP	5640
Twin 4.3L / V-6	175 EA	150 EA	6300
Twin 5.0L-DO	200 EA	175 EA	6500

- structural, 3-year whole boat protection, 1-year theft/accidental damage/liability coverage!
- Fuel tank, aluminum, in-floor, accessible
- Full width & depth plywood transom
- Hand lay-up woven fiberglass w/coremat reinforcement at the bulkheads
- Interlocking floor system w/five stringer reinforcement
- Maximum closed cell foam added for rigidity, sound deadening
- National Marine Manufacturers Association certification
- Premium gel coat w/superior buff back characteristics

- Premium marine carpet w/superior drying properties, durability, fade and mat resistance
- Premium marine vinyl made to Four Winns specifications
- Radio weatherband
- Shrink wrap shipping
- Slimline sidewall design for maximum cockpit space
- Smooth-riding, fast-planing deep-vee hull
- Stainless, rails, cleats through-bolted, metal-backed
- Unique stainless, deep access, swim ladder serves as assist rail in upright position
- Wood backing at all through-the-hull-and-deck fastening points

Additional Standard Features

Exterior and Trim

- Bow/stair rails, stainless, welded
- Chrome vents
- Cleats (6) stainless
- Deck hatches, (2) round
- Horn, flush mounted
- Navigation lights
- Non-skid walk-around deck
- Port lights (4)
- Swim platform, fiberglass, integrated w/ladder
- Walk-through transom door
- Windshield, tempered, curved glass

Functional and Convenience

- Bilge blower
- Color-coded wiring
- Compass
- Counter rotating props**
- Drain plug, brass
- Fused switches
- Hour meter(s)
- Instrumentation: fuel, oil pres., trim ind., water temp., speedometer, tachometer, voltmeter
- Power steering
- Power trim & tilt
- Props(s): stainless**
- Steering wheel, soft-feel
- Stereo AM/FM cassette

Interior

- Bell hatch cabin entry, pivoting, single track, bi-fold doors, plexiglass
- Cabin lights

- Canvas top and cockpit cover, color-coordinated
- Courtesy lights
- Curtains (privacy), mid-cabin
- Curtains, windows
- Dinette table, expandable fold-away
- Fiberglass cockpit liner, self-bailing
- Galley: alcohol stove, ice box, sink, storage
- Head, portable enclosed
- Indirect lighting (cabin)
- Mid-cabin
- Mirror
- Pillows (cabin decor)
- Seating: bucket (adjustable driver's), L-shaped passenger cabin
- Shower (pressurized)
- Sleeping for 4, vee-berth, mid-cabin
- Storage: bow area, sidewall
- Vanity & sink, enclosed

- Water inlet (dockside)
- Water storage (20 gal.)
- Windows, mid-cabin w/screens, side w/screens

Major Options

- Air conditioning
- Bow pulpit
- Color-matched trailer
- Convenience group
- Depth sounder
- Fiberglass transom door
- Full canvas package
- Halon automatic fire extinguishing system
- Microwave oven
- Radar arch
- Refrigerator
- Stereo upgrade w/60W equalizer, seek/scan, 4 coaxial speakers, LED clock

* Ask your Four Winns dealer for full details.
** See original text.

** Coverage may be continued for a 215 processing fee paid to the insurance broker.



1

1. Optional mirrored engine compartment with electric lift/sundeck.
2. Comfortable vee-birth with designer upholstery sleeps two.
3. Standard swivel bucket seats.



2



3

201 LIBERATOR

“What will we do for two whole days at the lake?” you ask...boy, have you been in the city too long! How 'bout parasailing, skiing, tubing, fishing, snorkeling, scuba diving, the waterfront bazaar (varsity shopper's mecca), breakfast/lunch/dinner at the pier, sunsets off the point, moonlight cruising. Give up? Come on up, bring sunglasses, sunscreen, and your sunny smiles...”

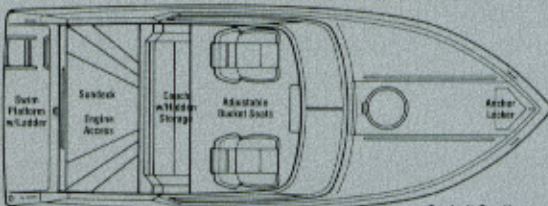

Cockpit Seating

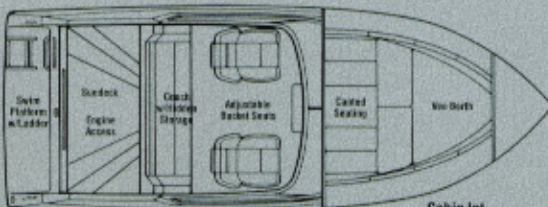

Cabin Int.



6

- Four Winns Extra Value Standard Features
- Anchor locker w/molded anchor well
 - Automatic bilge pump
 - Balsa core reinforced deck
 - Deep cycle, high cranking marine battery w/retainer
 - Easy maintenance gel coated bilge
 - Emergency engine shut-off
 - Engine compartment sound insulation
 - Ergonomically-designed helm for maximum convenience, comfort and safety
 - Exclusive *Winning Edge*™ 5/3/1 Owner Protection Plan*: 5-year hull



4. The 201's awesome performance...available with up to 350CI OMC King Cobra® stern drive.
5. Digital depth sounder.
6. Back-lit instrument panel is functional and attractive.

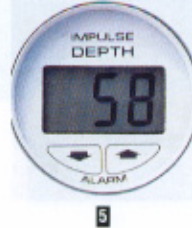

HIGH PERFORMANCE AND PRACTICALITY CO-EXIST.

The essence of the Four Winns 201 Liberator is a proprietary blend of performance and practicality. Uncompromised performance is apparent in the boat's lean silhouette...bold new graphics...standard steel prop(s)...and unmistakable performance. Yet the 201's practical side is also evident in its generous cabin...comfortable vee-berth...storage...and a stern couch.

Specifications

LOA/Transom to Bow:	20'9"/19'
Beam:	7'
Fuel (gal.):	1
Max. Cruise Range (mi.):*	1
Passengers:	
Maximum Capacity (lbs.):	15
Bridge Clearance:	3'
Cockpit Depth (helm):	3'
Draft (drive down):	3'
Trailer Weight, Empty (lbs.):	10

*Estimate. Actual Cruise Range may vary.

Power Ratings & Weights

Model	Crankshaft HP	Propshaft HP	Boat & Eng. Weight
5.0L-I/O / V-8	250 HP	175 HP	32
5.8L / V-8	235 HP	210 HP	33
5.7L / V-8	260 HP	220 HP	32
5.7L-LE / V-8	260 HP	220 HP	33
350 CI / V-8	270 HP	235 HP	33

structural, 3-year whole boat protection, 1-year theft/accidental damage/liability coverage!
Four Winns Sure Load™ Trailer, tandem axle, custom bunk, color-coordinated, w/detachable tongue
Fuel tank, aluminum, in-floor, accessible
Full width & depth plywood transom
Hand lay-up woven fiberglass construction
Interlocking floor system w/live stringer reinforcement
Maximum closed cell foam added for rigidity, sound deadening, and level flotation
National Marine Manufacturers Association certification

- Premium gel coat w/superior buff back characteristics
- Premium marine carpet w/superior drying properties, durability, fade and mat resistance
- Premium marine vinyl made to Four Winns specifications
- Quick-access hinged engine compartment lid
- Radio weatherband
- Shrink wrap shipping
- Slimline sidewall design for maximum cockpit space
- Smooth-riding, fast-planing deep-vee hull
- Stainless rails, cleats, ski eye...through-bolted, metal-backed
- Stainless, deep access, 3-step swim ladder

- Ultraviolet-resistant, self-storing canvas convertible top
- Wood backing at all through-the-hull-and-deck fastening points

Additional Standard Features

Exterior and Trim

- Bow/stair rails, stainless
- Cleats (4) stainless
- Deck hatch, round
- Gel coat, tri-tone
- Horn, flush mounted
- Navigation lights
- Swim platform, fiberglass, integrated w/stainless ladder
- Windshield, tempered, curved glass

Functional and Convenience

- Bilge blower
- Color-coded wiring
- Depth sounder
- Drain plug, brass
- Fused switches
- Instrumentation: fuel, oil pres., trim ind., water temp., speedometer, tachometer, voltmeter
- Power steering
- Power trim & till
- Prop, high performance
- Steering wheel, soft-feel
- Horn, flush mounted
- Stereo AM/FM cassette 60W equalizer, seek-scan w/weatherband, 4 speakers, LED clock

Interior

- Beverage holders, oversized (cockpit)
- Cabin door w/lock, plexiglass
- Cabin lights
- Canvas top, cockpit cover, color-coordinated
- Chart light
- Courtesy lights
- Engine compartment lights
- Mirror
- Passenger console w/lockable glove box and integrated, insulated ice chest
- Seating: cushioned aft sundeck, custom molded buckets (adjustable), stern couch, cabin
- Sleeping for 2: vee-berth
- Storage: sidewall, underberth, engine compartment

Major Options

- Engine hatch, electric assist w/mirror
- Exhaust, thru-hull w/mufflers
- Fiberglass cockpit liner
- Full canvas package
- Halon automatic fire extinguishing system
- Swim platform, teak insert

* Ask your Four Winns dealer for full details.
† Coverage may be continued for a \$15 processing fee paid to the insurance broker.



1



2



3



4

1. Bow anchor locker with molded anchor well stores anchor and line.
2. Remote stereo controls at the helm (standard).
3. Roomy vee-berth with designer upholstery sleeps two.
4. Passenger-side integrated, insulated cooler and lockable glove box.

221 LIBERATOR



"Dear 'Authority Figures'...
 Won the tournament! Beach volleyball has taken off...Pros earning big bucks. Considering staying out of school a year and trying the circuit. Think about it and we'll talk when I get home.
 P.S. Only using the credit card to gas the boat."

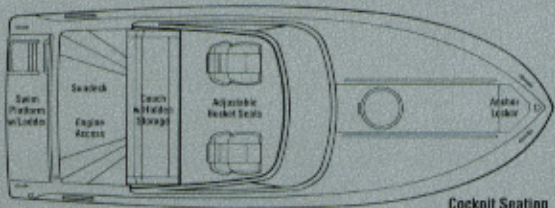

Cockpit Seating

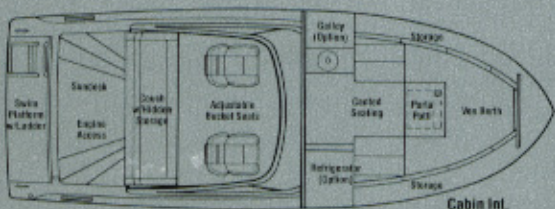

Cabin Int.



7

Four Winns Extra Value Standard Features

- Anchor locker w/molded anchor well
- Automatic bilge pump
- Balsa core reinforced hull
- Deep cycle, high cranking marine battery w/retainer
- Easy maintenance gel coated bilge
- Emergency engine shut-off
- Engine compartment sound insulation
- Ergonomically-designed helm for maximum convenience, comfort and safety
- Exclusive *Winning Edge*™ 5/3/1 Owner Protection Plan™: 5-year hull



- 5. Tandem-axle, color-matched Four Winns Sure Load™ trailer is standard
- 6. OMC King Cobra™ power delivery system with stainless steel prop
- 7. Premium instrumentation with stylish gauges, lighted rocker switches, padded wheel



6

5



ONE RIDE, AND YOU'LL KNOW WHY WE CALL 221 LIBERATOR DRIVERS "PILOTS."

Like all Liberator® models, the 221 is designed for the performance purist unwilling to compromise his or her need for civilized comforts. Such enthusiasts will revel in the 221's impressive OMC King Cobra® power... excellent power-to-weight ratio... pulse-quickenng silhouette... and sophisticated engine management system. They'll also appreciate Liberator extras, such as the spacious, stylish cuddy... comfortable seating... and integrated swim platform.



Specifications	
LOA/Transom to Bow:	23'3" / 21'8"
Beam:	8'4"
Fuel (gal.):	65
Max. Cruise Range (mi.):*	180
Passengers:	8
Maximum Capacity (lbs.):	2410
Bridge Clearance:	3'10"
Cockpit Depth (helm):	32"
Draft (drive down):	34"
Trailer Weight, Empty (lbs.):	1200

*Estimate. Actual Cruise Range may vary.

Power Ratings & Weights			
Model	Crankshaft HP	Propshaft HP	Boat & Engine Weights
5.8L / V-8	235 HP	210 HP	3810
5.7L / V-8	260 HP	220 HP	3750
5.7L-LE / V-8	260 HP	220 HP	3840
350CI / V-8	270 HP	235 HP	3840
454CI / V-8	330 HP	275 HP	3990
454CI-HO / V-8	370 HP	310 HP	3990

Major Options

- Cabin galley w/refrigerator
- Docking lights
- Engine hatch, electric assist w/mirror
- Exhaust, thru-hull w/mufflers
- Fiberglass cockpit liner
- Full canvas package
- Halon automatic fire extinguishing system
- Swim platform, leak insert

* Ask your Four Winns dealer for full details.
† Coverage may be continued for a \$15 processing fee paid by the insurance broker.

structural, 3-year whole boat protection, 1-year theft/accidental damage/liability coverage!
Four Winns Sure Load™ Trailer, tandem axle, custom bunk, color-coordinated, w/detachable tongue
Fuel tank, aluminum, in-floor, accessible
Full width & depth plywood transom
Hand lay-up woven fiberglass w/coremat reinforcement at the bulkheads
Interlocking floor system w/five stringer reinforcement
Maximum closed cell foam added for rigidity, sound deadening, and level flotation
National Marine Manufacturers Association

certification
• Premium gel coat w/superior buff back characteristics
• Premium marine carpet w/superior drying properties, durability, fade and mat resistance
• Premium marine vinyl made to Four Winns specifications
• Quick-access hinged engine compartment lid
• Radio weatherband
• Shrink wrap shipping
• Slimline sidewall design for maximum cockpit space
• Smooth-riding, fast-planing deep-vee hull
• Stainless rails, cleats, ski eye...through-bolted, metal-backed

• Stainless, deep access, 3-step swim ladder
• Ultraviolet-resistant, self-storing canvas convertible top
• Wood backing at all through-the-hull-and-deck fastening points

Additional Standard Features

- Exterior and Trim
- Bow/stair rails, stainless
 - Cleats (4) stainless
 - Deck hatch, round
 - Gel coat, tri-tone
 - Horn, flush-mounted
 - Navigation lights

- Swim platform, fiberglass, integrated w/stainless ladder
- Windshield, tempered, curved glass

Functional and Convenience

- Bilge blower
- Color-coded wiring
- Depth sounder
- Drain plug, brass
- Fused switches
- Instrumentation: fuel, oil pres., trim ind., water temp., speedometer, tachometer, voltmeter
- Power steering
- Power trim & tilt
- Prop, high performance
- Steering wheel, soft-feel
- Stereo AM/FM cassette
- GOW equalizer, seek-scan w/weatherband, 4 speakers, LED clock

Interior

- Beverage holders, oversized (cockpit)
- Cabin door w/lock, plexiglass
- Cabin lights
- Canvas top, cockpit cover, color-coordinated
- Chart light
- Courtesy lights (cockpit)
- Engine compartment lights
- Mirror
- Seating: cushioned all sundeck, custom molded bucket seats (adjustable), stern couch, cabin
- Sleeping for 2, vee-berth
- Storage: bow area, sidewall, underberth, engine compartment



1

1. Optional mirrored engine hatch/sundeck with electric lift.
2. Spacious dinette/vee-berth cuddy sleeps two.
3. Partial galley with service counter, sink and ice box.



2



3

251 LIBERATOR



"Thanks for the cool day...

If you were trying to impress me ...the boat, the dinner, the sunset – it worked! Know what impressed me most?...your cool control...the way you ignored those hot dogs who wanted to race...and the way you stayed clear of the couple fishing...and I loved going fast when there was nothing out front but open water. You don't scare me a bit (and that scares me a lot!)"

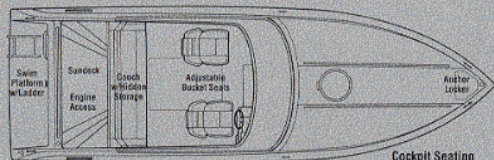

Cockpit Seating

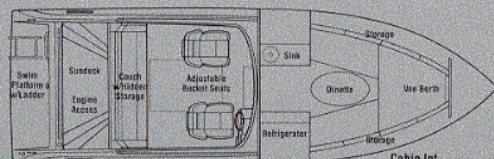

Cabin Int.

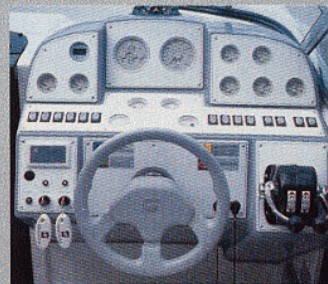

6

Four Winns Extra Value Standard Features

- Anchor locker w/molded anchor well
- Automatic bilge pump
- Balsa core reinforced deck and hull
- Deep cycle, high cranking marine battery w/retainer
- Easy maintenance gel coated bilge
- Emergency engine shut-off
- Engine compartment sound insulation
- Ergonomically-designed helm for maximum convenience, comfort and safety
- Exclusive *Winning Edge*™ 5/3/1 Owner Protection Plan*: 5-year hull



- 4. Four Winns Sure Load™ color-matched trailer (optional).
- 5. Motorized bolster seat (optional).
- 6. The 251's instrumentation is performance-oriented.



5



ONE OF THE WORLD'S MOST RESPECTED PERFORMANCE BOATS HAPPENS TO BE ONE OF THE SMARTEST.

Presenting the 251...power elite of the Four Winns Liberator® series. The legendary 251, with OMC King Cobra® V-8s, thundering wake, responsiveness, is sure to satisfy the most performance purist. Smart styling – wrap-around windshield, bold graphics, and distinctive hatch – add yet another measure of distinction. And intelligent features give the 251 Liberator a distinct edge over other performance models. *as if it needed another one!*

Specifications	
LOA/Transom to Bow:	26'2" / 24'
Beam:	8'
Fuel (gal.):	1
Water (gal.):	1
Max. Cruise Range (mi.):*	2
Passengers:	3
Maximum Capacity (lbs.):	1700
Bridge Clearance:	5'
Cockpit Depth (helm):	3'
Draft (drive(s) down):	3'
Trailer Weight, Empty (lbs.):	1700

*Estimate. Actual Cruise Range may vary.
Y = Yacht certified

Power Ratings & Weights			
Model	Crankshaft HP	Propshaft HP	Boat & Eng. Weig.
454CI / V-8	330 HP	275 HP	4600
454CI-HO / V-8	370 HP	310 HP	4600
Twin 5.0L-HO / V-8	200 EA	175 EA	5300
Twin 350CI / V-8	270 EA	235 EA	5500

structural, 3-year whole boat protection, 1-year theft/accidental damage/liability coverage[†]
 Fuel tank, aluminum, in-floor, accessible
 Full width & depth plywood transom
 Hand lay-up woven fiberglass w/coremat reinforcement at the bulkheads
 Interlocking floor system w/five stringer reinforcement
 Maximum closed cell foam added for rigidity and sound deadening
 National Marine Manufacturers Association certification
 Premium gel coat w/superior buff back characteristics
 Premium marine carpet w/superior drying

properties, durability, fade and mat resistance
 • Premium marine vinyl made to Four Winns specifications
 • Quick-access hinged engine compartment lid
 • Radio weatherband
 • Shrink wrap shipping
 • Slimline sidewall design for maximum cockpit space
 • Smooth-riding, fast-planing deep-vee hull
 • Stainless rails, cleats, ski eye...through-bolted, metal-backed
 • Stainless, deep access, 3-step swim ladder
 • Ultraviolet-resistant, self-storing canvas convertible top
 • Wood backing at all through-the-hull-and-deck fastening points

Additional Standard Features
 Exterior and Trim
 • Bow/stair rails, stainless
 • Cleats (6) stainless
 • Deck hatches (2), round
 • Gel coat, tri-tone
 • Exhaust, thru prop
 • Horn, flush mounted
 • Navigation lights
 • Prop(s), stainless
 • Swim platform, fiberglass, integrated w/stainless ladder
 • Transom light
 • Windshield, tempered, curved glass

Functional and Convenience
 • Battery switch (dual)**
 • Bilge blower
 • Color-coded wiring
 • Compass
 • Counter-rotating props**
 • Depth sounder
 • Drain plug, brass
 • Fused switches
 • Instrumentation: fuel, oil pres., trim ind., water temp. speedometer, tachometer, voltmeter, hour meter(s)
 • Power steering
 • Power trim & tilt
 • Steering wheel, soft-feel
 • Stereo AM/FM cassette 60W equalizer, seek-scan w/weatherband, remote, 4 speakers, LED clock

Interior
 • Beverage holders, oversized (cockpit)
 • Cabin door w/lock, plexiglass
 • Cabin lights
 • Canvas top, cockpit cover, color-coordinated
 • Chart light
 • Courtesy lights (cockpit)
 • Dinette table
 • Engine compartment lights
 • Fiberglass floor liner
 • Head, portable
 • Mirror
 • Pillows (cabin decor)
 • Recessed cabin lighting
 • Seating: cushioned alt sundeck, custom molded buckets (adjustable), stern couch, cabin
 • Sink

• Sleeping for 2; dinette converts to berth
 • Storage: sidewall, under berth, engine compartment
 • Water storage (20 gal.)

Major Options

- Color-matched trailer
- Engine hatch, electric assist w/mirror
- Exhaust thru-hull w/mufflers
- Full canvas package
- Halon automatic fire extinguishing system
- Power bolsters
- Refrigerator
- Swim platform, teak insert
- Trim tabs, hydraulic

*Ask your Four Winns dealer for full details.
 **Twin only.
 †Coverage may be discontinued for a \$15 processing fee paid to the insurance broker.



1



2

1. Prop selection line tunes performance.

2. OMC controls provide smooth, positive shifting over the full speed range and shift arc. Throttles feature thumb-activated power trim and tilt.

3-4. Johnson® and Evinrude® outboards offer loop-charging, VRO™ oil injection, "lost



3



4

THE POWER OF OMC®



"The reliable OMC propulsion system that powers each Four Winns boat is design-matched to the hull and running surface. Operating efficiency and fuel efficiency are optimal... power for skiing or cruising is just a throttle nudge away."

OMC Power Delivery System

To handle the higher torque of big block V-8s, a rugged OMC King Cobra® power delivery system features a bronze alloy cone clutch, machine-matched forged gears, an automotive type u-joint and hardened alloy drive shaft.

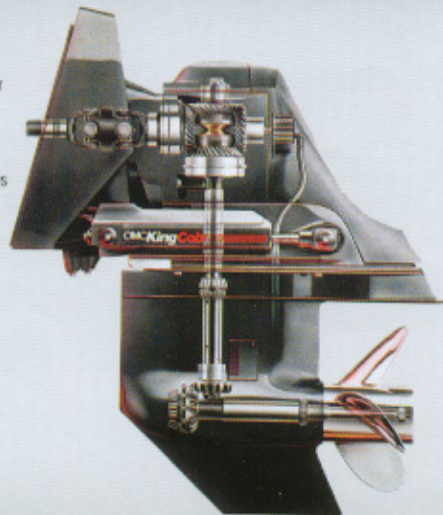

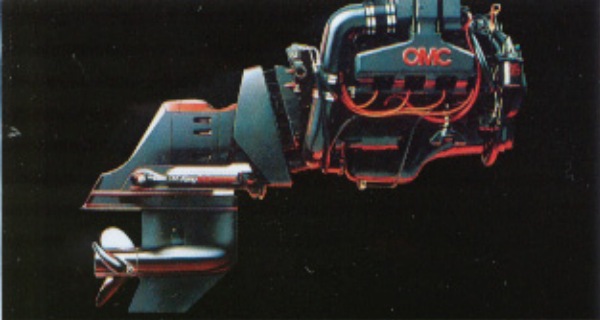

5

foam™ powerhead casting, 19-step corrosion protection and other sophisticated systems.

5. Mighty 454 OMC King Cobra® stern drives' impressive power-to-weight ratio combines outstanding performance with operating efficiency.

6. Spillfire™ electronic engine management monitors vital engine functions and tunes the engine under way. The "smart" system's S.L.O.W.™ overheat protection automatically reduces engine RPMs to compensate for overheating, over-revving or low oil pressure.



6

THE CONFIDENCE OF FOUR WINNS...THE POWER OF OMC.

While most other boat brands are still engaged in a race to accept a large range of power systems from a limited number of engine manufacturers, every Four Winns boat is designed to accept a design-matched to a limited range of rugged, reliable propulsion systems from Outboard Motor Corporation...a world leader in marine power and technology. That means assured performance for the boating lifestyle you pursue - from every engine recommended for cruising, fishing - from every engine recommended or offered on your Four Winns boat.

The popular OMC Cobra® and OMC King Cobra® designs have continuously evolved since their introduction in 1984...pioneering electronic engine management systems and advancing the technology of stern drive propulsion.

Johnson® and Evinrude® are the best-known selling outboard brands in the world. Advanced features like loop-charging, VR0™ oil injection, foam powerhead casting, and a 19-step corrosion protection system assure their continued popularity.

OMC engine controls provide smooth, precise shifting over the full speed range and shift.

All OMC power systems have an enviable reputation for long life, dependable service, outstanding performance and excellent operating efficiency. That's why we have the confidence to back them twice over - by the OMC 1 + 2™ protection plan...and again by the Four Winns Winning Edge™ 5/3/1 Corrosion Protection Plan.

FOUR WINNS MODEL AVAILABILITY

ENGINE SPECIFICATIONS

Model	FOUR WINNS MODEL AVAILABILITY											ENGINE SPECIFICATIONS														
	170 Freedom	190 Freedom	195 Freedom	180 Horizon	200 Horizon	220 Horizon	180 Canadia	200 Canadia	205 Sundowner	225 Sundowner	265 Sundowner	235 Vega	265 Vega	201 Liberator	221 Liberator	251 Liberator	Propshaft HP	Crankshaft HP	Displ. (L/cyl. in.)	Bore Stroke (in.)	Comp. Ratio	Carburetion	Operating Range Full Throttle (RPM)	Total Wt. (lbs.)	Gear Ratio	Max. Prop Diameter
OMC Cobra®																										
3.0 Litre 4-cyl.	A	A														115	130	3.0/181	4.00 x 3.60	9.3:1	2.66:	4200-4600	550	136:1	15½"	Opt.
3.0 Litre High Output 4-cyl.	A	A	A	A		A										130	150	3.0/181	4.00 x 3.60	9.3:1	2.66:	4200-4600	580	136:1	15½"	Std.
4.3 Litre 6-cyl.		A	A	A	A	A	A	A	A*	A*						150	175	4.3/262	4.00 x 3.48	9.3:1	2.66:	4200-4600	806	138:1	15½"	Std.
5.0 Litre High Output 6-cyl.			A	A	A	A	A	A	A*	A*	A	A		A*		175	200	5.0/302	4.00 x 3.00	8.3:1	2.66:	4000-4400	906	139:1	15½"	Std.
5.8 Litre 8-cyl.				A	A	A	A	A	A	A	A	A	A	A		210	235	5.8/351	4.00 x 3.50	8.3:1	4.66:	4000-4400	976	141:1	15½"	Std.
5.7 Litre 8-cyl.				A	A	A	A	A					A	A		220	260	5.7/350	4.00 x 3.48	9.3:1	4.66:	4200-4600	911	141:1	15½"	Std.
5.7 Litre Limited Edition 8-cyl.				A	A	A	A	A	A	A	A	A	A	A		220	260	5.7/350	4.00 x 3.48	9.3:1	4.66:	4200-4600	1025	142:1	17"	Std.
OMC King Cobra®																										
350 cu. in. 8-cyl.				A	A	A	A	A	A				A	A	A*	236	270	5.7/350	4.00 x 3.48	9.3:1	4.66:	4200-4600	1005	142:1	17"	Std.
454 cu. in. 8-cyl.					A			A	A	A	A		A	A		275	330	7.4/454	4.25 x 4.00	8.4:1	4.66:	4200-4600	1155	142:1	17"	Std.
454 cu. in. High Output 8-cyl.														A	A	310	370	7.4/454	4.25 x 4.00	8.4:1	4.66:	4000-5000	1155	142:1	17"	Std.

A = Available *Twin engine w/counter rotating props

FOUR WINNS MODEL AVAILABILITY

ENGINE SPECIFICATIONS

Model	FOUR WINNS MODEL AVAILABILITY							ENGINE SPECIFICATIONS									
	170 Freedom	190 Freedom	195 Freedom	180 Horizon	200 Horizon	180 Canadia	205 Sundowner	Engine Type	Bore Stroke (in.)	Displacement	Carburetion	Operating Range Full Throttle (RPM)	Weight (lbs.)	Gear Ratio	Power Trim & Tilt	Alternator	
90 HP ML	A							90° V-4	3.500 x 2.588	99.6 (1632cc)	Two, Dual-Throat	4500-5500	298	13.25 (50)	Opt.	3/9 amp.	
90 HP TL	A							90° V-4	3.500 x 2.588	99.6 (1632cc)	Two, Dual-Throat	4500-5500	301	13.25 (50)	Std.	3/9 amp.	
120 HP TL	A	A						90° V-4	3.685 x 2.588	122 (2000cc)	Two, Dual-Throat	5000-6000	365	13.25 (50)	Std.	3/9 amp.	
120 HP TX			A	A		A		90° V-4	3.685 x 2.588	122 (2000cc)	Two, Dual-Throat	5000-6000	370	13.25 (50)	Std.	3/9 amp.	
140 HP TL		A						90° V-4	3.685 x 2.588	122 (2000cc)	Two, Dual-Throat	5000-6000	365	13.25 (50)	Std.	3/9 amp.	
150 HP TX			A	A	A	A	A	90° V-6	3.500 x 2.588	149.4 (2448cc)	Three, Dual-Throat	4500-5500	385	14.26 (54)	Std.	3/9 amp.	
150 HP TX/EX			A	A	A	A	A	60° V-6	3.600 x 2.588	158 (2589cc)	Two, Triple-Throat	4500-5500	359	14.26 (54)	Std.	35 amp.	
175 HP TX					A	A		90° V-6	3.625 x 2.588	160.3 (2626cc)	Three, Dual-Throat	4750-5750	401	14.26 (54)	Std.	35 amp.	
175 HP TX/EX					A	A		60° V-6	3.600 x 2.588	158 (2589cc)	Two, Triple-Throat	4500-5500	359	14.26 (54)	Std.	35 amp.	

A = Available ML = Manual Tilt/Long Shaft TL = Power Trim & Tilt/Long Shaft TX/EX = Power Trim & Tilt/Extra Long Shaft



1



2

1. Custom fit and finish is assured in our sewing shop.
2. Bow canvas cover fits snugly and securely... facilitates water run-off.
3. Optional bow canopy folds and stores easily (220 Horizon only).

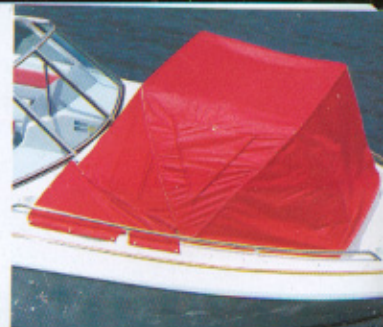

3

CANVAS / COLORS

Your Winns offers a variety of canvas and color options to help personalize your boat and outfit your boating lifestyle. Your Winns dealer can help you select that special combination of vinyl coat colors and color-matched canvas that will make your new Winns beautiful, functional, and a pleasure to own in the years to come."

Full camper canvas and bow cover (optional)



FREEDOM

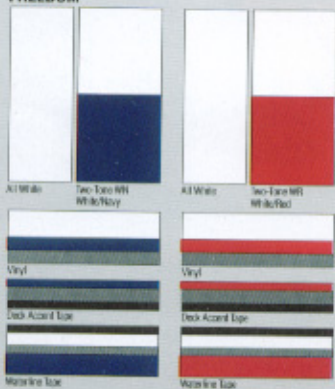

HORIZON/CANDIA

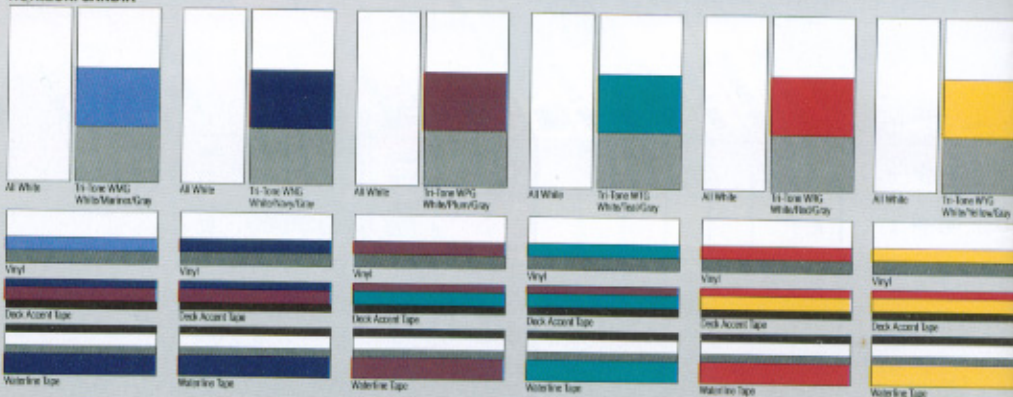

VISTA

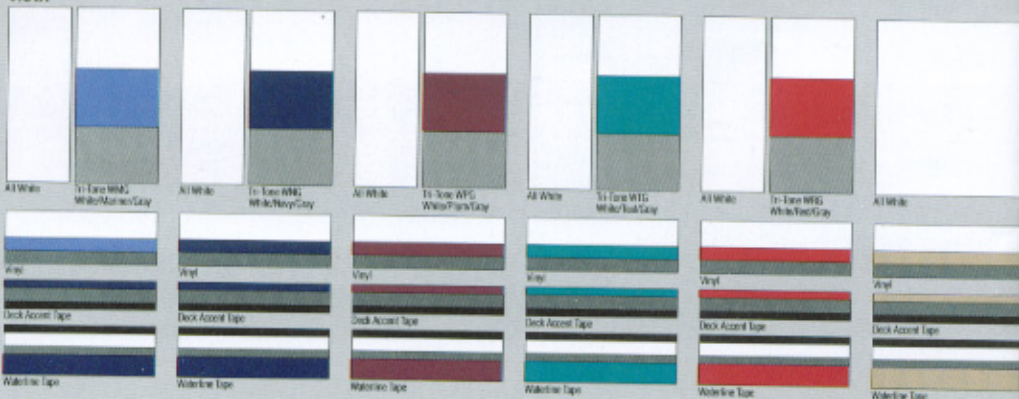



4. Four Winns Vista cruiser with full camper canvas.
5. Optional walk-through curtain.



4

5

Sunbrella convertible top (standard).



Sunbrella convertible top with aft and side curtains (optional).



Bow cover and cockpit cover (optional).



Full mooring cover (optional).

CANVAS: QUALITY IS TOP PRIORITY

The complete selection of canvas configurations now offered in fade-resistant, UV-treated canvas. Canvas tops and mooring covers increase your boat's versatility, guard against the elements, and protect your boating investment.

Mooring and cockpit covers feature support rods to promote rainwater runoff, reinforced seams, high-quality fasteners, Velcro® and large-tooth nylon zippers for greater strength and convenience. Inserts are crafted from durable clear plastic. We even sew our own canvas. Canvas covers will fit snugly and securely. And, all top colors are coordinated with your boat's

COLORS: THE QUALITY SHINES THROUGH

Looks like this will be our brightest year... thanks to contemporary new color selections. And we give you more color choices than Four Winns!

Four Winns' vibrant gelcoat colors are a testament to our superior production techniques. While some boat builders utilize light colors to avoid print-through or hull distortion, Four Winns uses bold, rich colors – while imposing rigorous production standards. In addition, we utilize premium gelcoat which buffs back to its original color year after year.

Color-coordinated vinyls are made to meet our specifications...UV-treated...stain, mildew resistant...with "memory" to retain its shape. Our carpets are the finest in terms of durability, mat-resistance – as well as cut and fit.

SUNDOWNER

LIBERATOR



1



2

1. Automatic bilge pump.
 2. Windshield wiper(s).
 3. Wrap-around stern couch.
- Fill-in cushions form spacious sun lounge.



3

4. Tri-tone gel coat (standard on Liberator® models). Newer, brighter color choices for 1991!

OPTIONS/ACCESSORIES



1



2



3



4



5



6



7



8



9



10



11



12



13



14



15



16

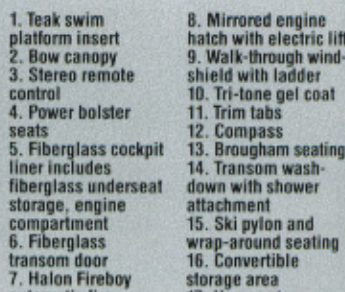

17

"All Four Winns models are ready for use the day they are put in the water. However, there are many applications that Four Winns boats can fulfill. That's why we offer a wide range of options and accessories designed to contribute comfort and convenience, enhance the value, extend the utility, and/or add to your enjoyment while boating."

1. Teak swim platform insert
2. Bow canopy
3. Stereo remote control
4. Power bolster seats
5. Fiberglass cockpit liner includes fiberglass underseat storage, engine compartment
6. Fiberglass transom door
7. Halon Fireboy automatic fire extinguishing system
8. Mirrored engine hatch with electric lift
9. Walk-through windshield with ladder
10. Tri-tone gel coat
11. Trim tabs
12. Compass
13. Brougham seating
14. Transom wash-down with shower attachment
15. Ski pylon and wrap-around seating
16. Convertible storage area
17. Hour meter



4

- a = available
- s = standard
- 1 = included in SLX pkg.
- 2 = convertible model
- 3 = standard twin
- 4 = outboard model only
- 5 = standard brougham
- 6 = brougham only
- 7 = requires cockpit galley
- = not available

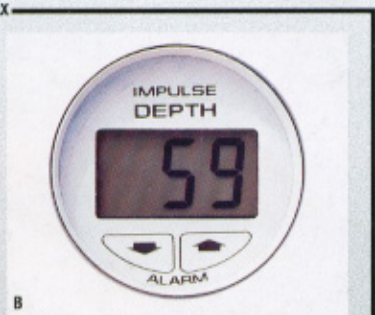
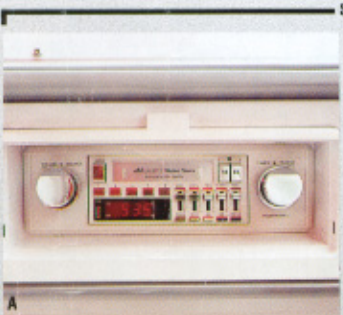

SLX Package
 A. Premium stereo/cassette upgrade w/noise suppressor
 B. Depth sounder
 C. Courtesy lights
 D. 12V DC dash receptacle
 E. Bow fill-in cushions
 F. Color-matched cockpit/bow cover

SLX 1: Also includes color-coordinated convertible top, forward cover (Horizon only), and cockpit cover.
SLX 2: Also includes color-coordinated convertible top, forward cover (Horizon only), and side and aft curtains.
SLX 3: Also includes color-coordinated convertible top, forward cover (220 Horizon only), and camper.

Major Option Packages
Brougham Package: Includes rear sundeck, helm and passenger molded swivel bucket seats with integrated headrests and side bolsters; full-width stern couch. 225 and 255 Sundowner includes split sundeck with walk-through transom.
Sport/Fishing Package: Includes bucket seat, insulated fishwell, fiberglass cockpit liner.
Fish and Ski Package: Includes ski pylon, trolling motor, pedestal seat.
Horizon/Candia Convenience Package: Includes compass, starboard windshield,

wiper, automatic bilge pump switch, hour meter, dual batteries, anchor w/line.
Sundowner Convenience Package: Includes compass, hour meter, anchor w/line.
235, 265 Vista Convenience Package: Includes refrigerator, electric stove, hot water system, dockside battery charger/isolator/110V.
235, 265 Vista Cruise Package: Includes compass, transom wash-down system, port/starboard windshield wipers, halon fireboy, deck sunpads.

	170 Freedom	190 Freedom	195 Freedom	180 Horizon	200 Horizon	220 Horizon	180 Candia	200 Candia	205 Sundowner	225 Sundowner	255 Sundowner
A/C & HEATING											
ALCOHOL STOVE, 1 BRNR				a ¹	a ¹	a ¹	a ¹	a ¹	a ¹	a ¹	a ¹
ELEC. STOVE											
ANCHOR W/ LINE	a	a	a	a	a	a	a	a	a	a	a
AUTO BILGE PUMP	a	a	s	a	a	a	a	a	s	s	s
BOW PULPIT											
BROUGHAM INTERIOR (I/O)	a	a		a	a	a	a	a	a	a	a
CANVAS: AFT	a	a	a	a	a	a		a	a	a	a
BOW CANOPY						a					
CAMPER						a			a	a	a
COCKPIT COVER	a	a	a	a	a	a			a	a	a
FORWARD	a	a		a	a	a					
FULL	a	a	a	a	a	a			a	a	a
MOORING COVER	a	a	a	a	a	a	a	a	a	a	a
SIDES	a	a	a	a	a	a			a	a	a
WALK-THRU CURTAIN	a	a		a	a	a					
12V DC RECEPTACLE				a ¹	a ¹	a ¹	a ¹	a ¹	a ¹	a ¹	a ¹
C/O MONITOR											
COCKPIT GALLEY OPTIONS 1,2				a	a	a	a	a	a	a	a
COMPASS				a	a	a	a	a	a	a	a
CONVENIENCE GROUP				a	a	a	a	a	a	a	a
DECK SUNPAD											
DEPTH SOUNDER				a ¹	a ¹	a ¹	a ¹	a ¹	a ¹	a ¹	a ¹
DOCKSIDE PWR/ISOL. BAT CHG. SWITCH & ADAPT											
DUAL BATTERY SWITCH				a	a	a	a	a	a	a	a
ELECTRIC HATCH W/MIRROR											
FIBERGLASS FLOOR LINER (W/WINDLASS SEAT BCR, ENGINE COVER)				a	a	a			a	a	s
FLUSH OUT KIT (I/O ONLY)	a	a	a	a	a	a	a	a	a	a	a
GAS VAPOR DETECTOR											
GREY WATER SYSTEM											a
HALON FIREBOY (I/O ONLY)				a	a	a	a	a	a	a	a
HATCH SCREEN		a								a	a
HEAD: ENCLOSED										a	s
PORTABLE				a	a ¹	a ¹	a		a	a	
PUMP OUT		a								a	a
HORN, DUAL TRUMPET										a	a
HOUR METER (I/O ONLY)							a	a	a	a	a
LIGHTS: COURTESY				a ¹	a ¹	a ¹	a ¹	a ¹	a ¹	a ¹	a ¹
DOCKING											
SPOT/FLOODLIGHT REMOTE (REQ. BOW PULPIT)											a
MICROWAVE											
PILLDW PACKAGE											
POWER INVERTER											
PROP. HIGH ALT./HEAVY LOAD	a	a	a	a	a	a	a	a	a	a	a
PROP. STAINLESS (EXCHANGE)	a	a	a	a	a	a	a	a	a	a	a
RADAR ARCH											
REFRESHMENT CENTER W/GALLEY											
REFRIGERATOR											a
SEATING: BOLSTER (POWER)											
BOW FILL-IN CUSHION				a ¹	a ¹	a ¹	a	a			
BUCKET, BOTH	a ¹	a ¹	a	a ¹	a ¹	a ¹	s	s	a ¹	a ¹	a ¹
BUCKET, STARBOARD	s	s	s	a ¹	a ¹	a ¹	s	s	a ¹	a ¹	a ¹
BUCKET & FISHWELL					a	a			a	a	a
COMPANION COUCH (SWIVEL)											
L-SHAPED, SWIVEL											
LOUNGER, BOTH	a	a	a	s	s	s			s	s	s
PORT ADJUSTER				a ¹	a ¹	a ¹	s	s	a ¹	a ¹	a ¹
STERN COUCH											
WRAP-AROUND STERN COUCH	s ¹	s ¹	s ¹	a ¹	a ¹				a ¹	a	a
W/FILL-IN CUSHIONS	a ¹	a ¹	a ¹	a ¹	a ¹				a ¹	a	a
SHIP TO SHORE											a
SHOWER CURTAIN											
SKI PYLON (OB)	a	a		a	a		a				
SKI TOW (I/O)	s	s	s	s	s	s	s	s	s	s	s
SLX OPTION 1							a	a	a	a	a
SLX OPTION 2							a	a	a		
SLX OPTION 3									a	a	a
SNAP-IN CARPET							a	a	a	a	a
STEERING, HYDRAULIC	a ¹	a ¹	a ¹	a ¹	a ¹		a ¹		a ¹		
STEREO- REMOTE											
UPGRADE				a ¹	a ¹	a ¹	a ¹	a ¹	a ¹	a ¹	a ¹
SWIM PLATFORM: TEAK INSERT (I/O)				a	a	a	a	a	a	a	a
TABLE											
TABLE W/EXTRA MOUNT							a	a	a	a	a
THRU HULL EXHAUST							a ¹	a ¹			
TRAILER (SINGLE AXLE)											
TRAILER (TANDEM AXLE)							s	s	s	s	a
TRANSOM WASHDOWN & SHOWER										a ¹	a ¹
TRI-TONE GEL COAT				a ¹	a ¹	a ¹	a ¹	a ¹	a ¹	a ¹	a ¹
TRIM TABS							a				a
WATER HEATER											
WINDLASS - CHAIN											a
WINDSHIELD CONSOLE							a	a			
WINDSHIELD WALK-THRU W/LADDER		a							a	a	
WINDSHIELD WIPER, STBD							a	a	a	a	a
WINDSHIELD WIPER, STBD & PORT									a	a	a

Not all options are available on all Four Winns models. See options availability chart at right.

YOUR FOUR WINNS DEALER...

HE'S OUR VALUED PARTNER, AND YOUR FAMILY BOATING SPECIALIST.

ed thumbing through Boating Lifestyles noticed, we've tried to be, informative and g a magazine format. The back cover is the pre- cisers pay more for this position. We've reserved about our Four Winns retailers because we mer members of Team s who make us so o confident and com- g lifestyle.

buzz word... We are sng those who repre- e marketplace. We visit ities. And they spend a n us... touring our man- Cadillac, Michigan and n, Texas... learning the ss of our boats... and s and benefits that add sh Four Winns boats ds. We make it tough ns Dealer because we ed by the strongest, le, helpful and profes- n your location.

unication is constant ns dealer and the fac- ack and forth on a daily Managers visit their each year. We work side t their boat shows. And their service technicians ns boat systems.

he Four Winns Profes- takes a very active role entation of new model e of the mainstays of ealer show is the dealer odels. They crawl over, rough them... rev them t our lakeside test e are doing right, and ove. And we listen... xperts who know what ilies want and need.



We help them take some of the hassle out of boating... To help our dealers do their job better, and to help make boating as enjoyable and hassle-free as possible for family boaters we provide an excellent mix of stylish, feature-packed boat models and a lot of support:

- 36 distinctive Four Winns models from affordable 17-foot runabouts to stately 36-foot live-aboard cruisers.
- 24 exciting, comfortable, complete and affordable boat/motor/trailer packages... all factory tested, cleaned and water-ready.
- Computerized parts inventory control for fast turn-around on dealer orders. We want you back on the water... fast!
- The colorful, exclusive WINNgear™ line of active wear and boating accessories.
- At participating dealers, fashionable Top of the Dock... America's Boating Lifestyle Stores™... in dealer Shoppes or convenient mall locations... where you can shop for Four Winns boats and for apparel and accessories that complement the boating lifestyle.

• **Winning Edge™ 5/3/1 owner protection.*** Standard on all trailerable boats, the plan provides a 5-year hull structural warranty. Also, 3-year whole boat owner protection covering all major boat systems and components and the Four Winns Sure Load™ trailer for one year of limited warranty followed by two years extended protection. Plus, each boat has been insured by Four Winns for theft, liability, and accidental damage with a deductible charge per claim. You may choose to continue this insurance for a \$15 processing fee. This plan is transferable to subsequent owners, for a \$25 transfer fee, for the balance of time remaining in the original program.

**You and your family are special to us. We think you deserve a specialist... see your Four Winns Professional Marine Retailer and...
...Give Your Family Our Best.**

*Ask your Four Winns dealer for complete details.



ADDITIONAL BOATS OFFERED BY FOUR WINNS:

- **Four Winns wide-body cruisers...** We also offer a complete line of wide-body live-aboard cruisers from 28- to 36-feet. These cruisers offer complete amenities, comforts, and practical design features for your enjoyment on the water. Ask your dealer for the Four Winns Cruiser Portfolio.
- **Four Winns fishing boats...** We've just introduced a brand new line of Quest by Four Winns center console and walk-around cuddy fishing boats. Quest by Four Winns fishing boats represent the latest design innovations and technologies for sport fishing enthusiasts. These special function boats will be sold and serviced only by a qualified group of marine fishing retail professionals in select regions. Please write to Four Winns for a copy of Quest by Four Winns fishing boat product literature.



FOUR WINNS®

4 Winn Way
Cadillac, Michigan 49601
(616) 775-1351