

FOUR WINNS

# 365

## EXPRESS

**The newest and freshest breath of life in the cruiser class...** To stand out among formidable alternative cruisers, we've taken care to provide all the quality, elegance, comfort and convenience expected, while endowing the 365 with innovations rarely seen or unavailable on other cruisers. For example, a portside companion seat pivots fore and aft for cockpit socializing. Lockable fore deck hatches conceal fenders and other dockside needs. A wide vinyl bumper surrounds the stern to help protect in docking maneuvers. It's all part of Four Winns' measured plan to breathe new life into the cruiser class.

As with all Four Winns boats, the exterior is 100% Armorcote, a premium finish specially formulated to resist fading and chalking. In 12-month continuous exposure testing in the Florida sun, the Armorcote finish retained more than 80% of its original gloss without maintenance.



Other gel coats retained less than 40%.

Extensive scale model testing helped define the 365's variable deadrise running surface that provides optimum handling underway, and welcome stability at rest.



A rugged and rigid fiberglass stringer system – impervious to rot and delamination – provides a solid foundation for the balsa-core reinforced hull and deck.

An adjustable companion helm seat overlooks an impressive molded dash fitted with a remarkably vast, but well-organized array of VDO gauges, controls and ancillary telemetry. Space is provided to give add-on electronics an integrated look.



A broad, one-level nonskid walk-around begins at the transom, not at mid-ship as with some other cruisers. This feature, combined with molded sidewall steps, makes dockside entry convenient.

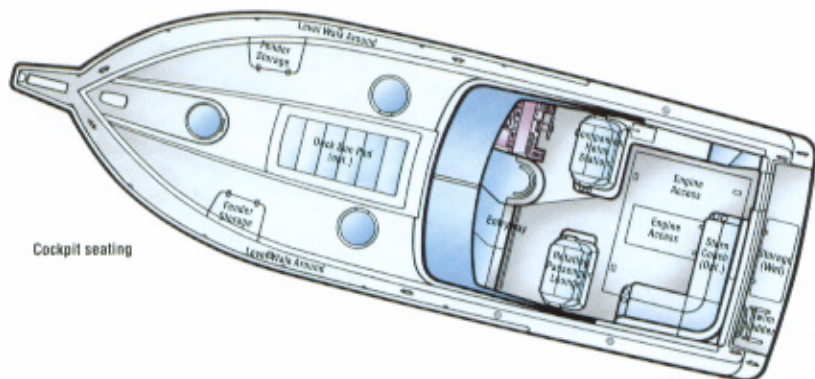

Cockpit seating



Locker/fender storage

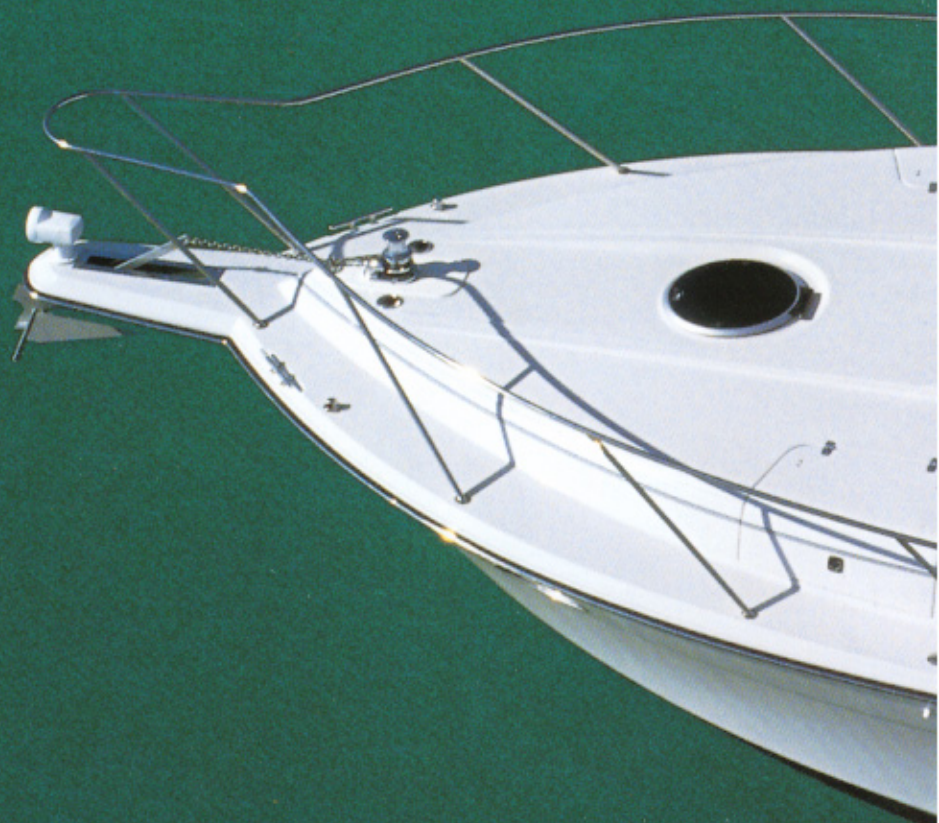

### 365 EXPRESS

LDA/Transom to Bow:	39' / 36'
Beam:	13' 2"
Fuel (gal.):	300
Water (gal.):	98
Max. Cruise Range (mi.): <sup>1</sup>	350
Passengers:	15
Bridge Clearance:	9' 8" / 10' 9" w/ radome
Cockpit Depth (helm):	44"
Draft:	36"

<sup>1</sup> Estimate. Actual cruise range may vary.  
<sup>2</sup> Drive(s) down where applicable.



Helm station



Refreshment center



Swivel companion seat



# 365 EXPRESS

**Life aboard a family cruiser ceases to be a compromise...** Below deck, the 365 Express is a virtual on-water condo. Careful adherence to ergonomic design efficiencies helps to maximize cabin use allowing room for living amenities ...generous headroom...and an amazing amount of space for gear stowage. Natural light from three large round deck hatches and panoramic side windows, and the artful blending of soft colors, elegant fabrics and subtle textures produces a wonderfully spacious and airy ambiance.

In many express designs, cabin headroom is sacrificed to maintain a low-to-the-water silhouette. The 365 is an exception with 6'9" of ceiling height, and a dressing area for the mid-cabin suite with a ceiling over 7' high.



In the master vee-berth, with built-in dressers and hanging closet, a queen-size bed conceals an optional waterjet spa. Designed to be used in port, the spa can be filled and heated after docking to provide a soothing massage of pulsating hot water. In the morning, the spa empties in minutes for timely departure. The tub doubles as a large, under-berth storage compartment.



In the 365, you won't have far to look for a place to store the drop-leaf dinette table and floor post...they're designed to hide away behind the portside settee back cushions. To accommodate more dinner guests, salon easy chairs can be moved to the table.

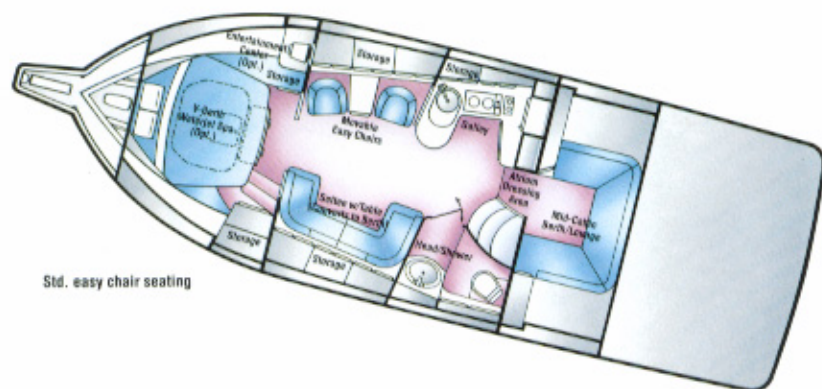

Galley/kitchen center



Head



Mid-cabin lounge



Optional spa





# 325/315 EXPRESS

The true test of a wide-body liveaboard is how "livable" it truly is...

Some cruiser cockpits use space-eating fixed seating. The 315/325 cockpits keep options open. The passenger seat swivels fore and aft. Optional refreshment center and wrap-around couch convert the stern for entertaining. The 315/325 also depart from traditional cruisers in cabin choices...a master vee-berth with or without a privacy bulkhead...a fixed dinette, or casual salon dining. Whatever layout you select, the space, amenities and ambiance expected are abundantly present.



The 285 and 315 offer technologically advanced stern drive 5.0L and 5.8L OMC Cobra V-8s with multi-port electronic fuel injection for better performance and fuel economy, and quick, sure starts. Crusader 454CI and 502CI V-drive V-8s power 325 and 365 Express models. Cummins 300B in-line 6 cyl. diesels are available on the 365.

An unshakable commitment to ergonomic design is notable at the helm where seat height, seat adjustment, line of sight, instrument layout and throttle/shifter positioning are carefully integrated to create a functional, convenient, aesthetically-pleasing operator environment.



All Four Winns Express cruisers feature Sunbrella color-matched, UV-stable canvas to extend boat versatility and protect your investment. Optional full Sunbrella canvas utilizes large nylon zippers and Velcro fasteners for convenience. Red/green color-coding makes it easy to tell port side canvas from starboard side.

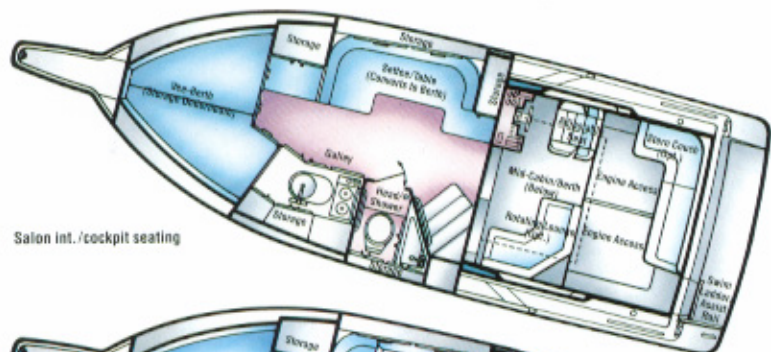
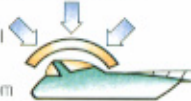

Salon int./cockpit seating

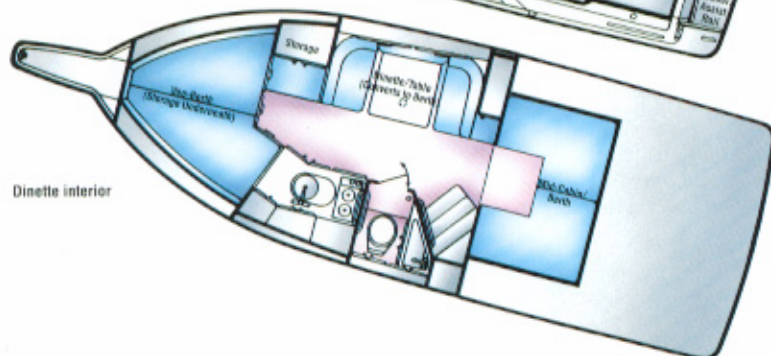

Dinette interior

315 EExpress (upper) 325 Express (lower)



Helm station



## 325/315 EXPRESS

LOA/Transom to Bow:	30'6" (325); 30'6"/28'6" (315)
Beam:	11'
Fuel (gal.):	180
Water (gal.):	35
Max. Cruise Range (mi.):*	160 (325); 280 (315)
Passengers:	12
Bridge Clearance:	7'6"/9' w/arch
Cockpit Depth (helm):	34"
Draft:	34" (325); 40" (315)

\*Estimate. Actual cruise range may vary. Drivers: down where applicable.



Main salon/mid-cabin



Companion helm seat



Available dinette seating



Main salon/forward berth



Galley



Head

# 285 EXPRESS

The cruising lifestyle is full of pleasant surprises...Four Winns' most affordable cruiser sacrifices nothing in comfort, convenience and luxury. An expansive cockpit is accessed through an integrated transom door with storage. The helm features VDO gauges. A sliding hatch provides entry to gracious living below. A wrap-around settee occupies the fore-cabin. Fill-in cushions and a removable table transform the area for sleeping or dining. An optional fixed dinette is also available. The mid-cabin offers a generous berth, or a private place to read or rest.

All Four Winns Express cruisers are backed by one of boating's strongest protection plans...exclusive Four Winns *Winning Edge™* Owner Protection which includes a 5-year hull structural warranty and a 1-year limited warranty on the powertrain and all other boat systems and components. See your dealer for details.



We've been as selective in choosing fabrics and floor coverings as you might be in decorating your home. Rich carpeting with Olefin fibres repels stains and returns to a fresh, plush appearance with the sweep of a vacuum. Watercolor textured vinyl is soft to the touch yet rugged, stain-resistant, and UV-stable.



Perhaps the most important value feature is the Four Winns Professional Marine Retailer. A select group of dealers have been carefully screened for their commitment to customer satisfaction and their dedication to making on-board living gracious and rewarding.

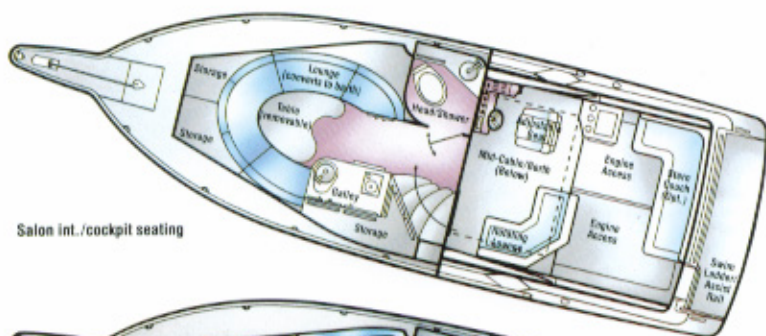

Salon int./cockpit seating

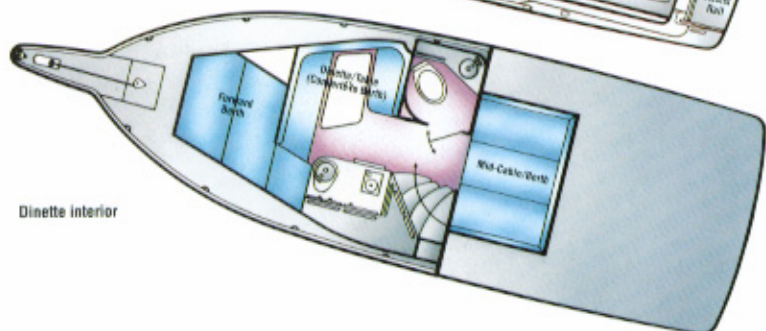

Dinette interior



Cockpit galley (opt.)

Helm station



## 285 EXPRESS

LOA/Transom to Bow:	28'11" / 27'5"
Beam:	10'2"
Fuel (gal.):	140
Water (gal.):	35
Max. Cruise Range (mi.):*	250
Passengers:	12
Bridge Clearance:	7'3"/8'6" w/arch
Cockpit Depth (helm):	34"
Draft:	39"

\* Estimate. Actual cruise range may vary. Drives† down where applicable.





Mid-cabin berth



Rotating passenger seat



Forward settee/berth



Available dinette seating



Galley



Head

# EXPRESS

Create a pleasant environment that suits your cruising lifestyle...The

Four Winns 285/315/325/365 Express wide-bodies are designed for maximum livability. Cabins are remarkably spacious...furnishings comfortable and exquisitely tailored...fixtures and hardware offer a simple elegance...head and galley modules provide outstanding utility, yet occupy minimal floor space...richly textured headliner and wall coverings contribute to the light and easy atmosphere. We designed in the livability but left individual lifestyle touches in your hands. Choose from rich colors and fabrics, attractive patterns, and dozens of comfort and convenience options to create a pleasant environment that suits your cruising lifestyle.

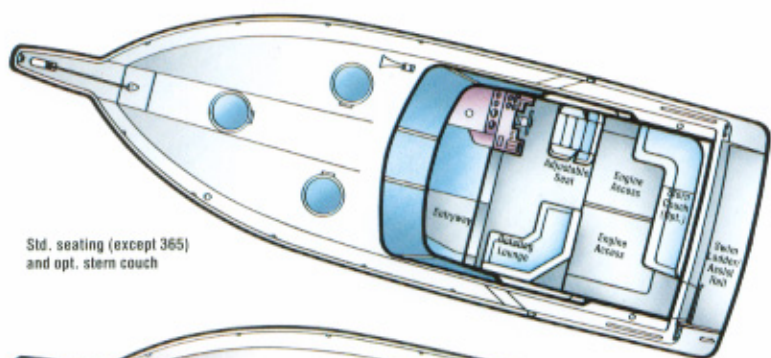

Std. seating (except 365) and opt. stern couch

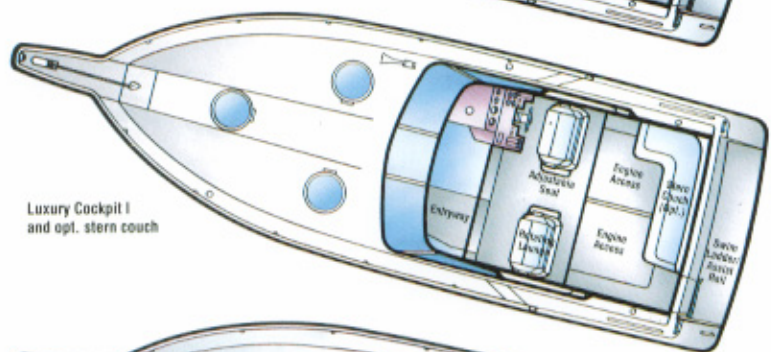

Luxury Cockpit I and opt. stern couch

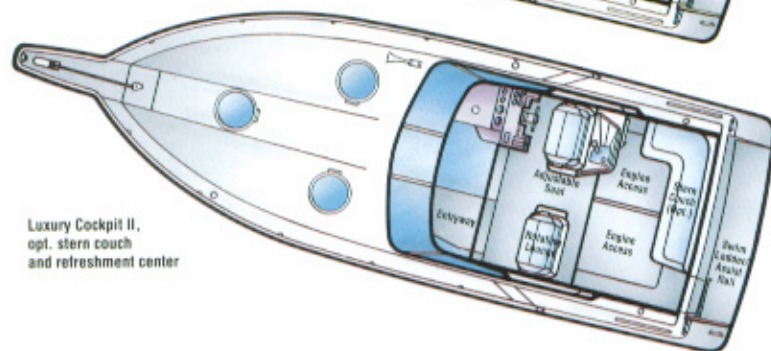

Luxury Cockpit II, opt. stern couch and refreshment center

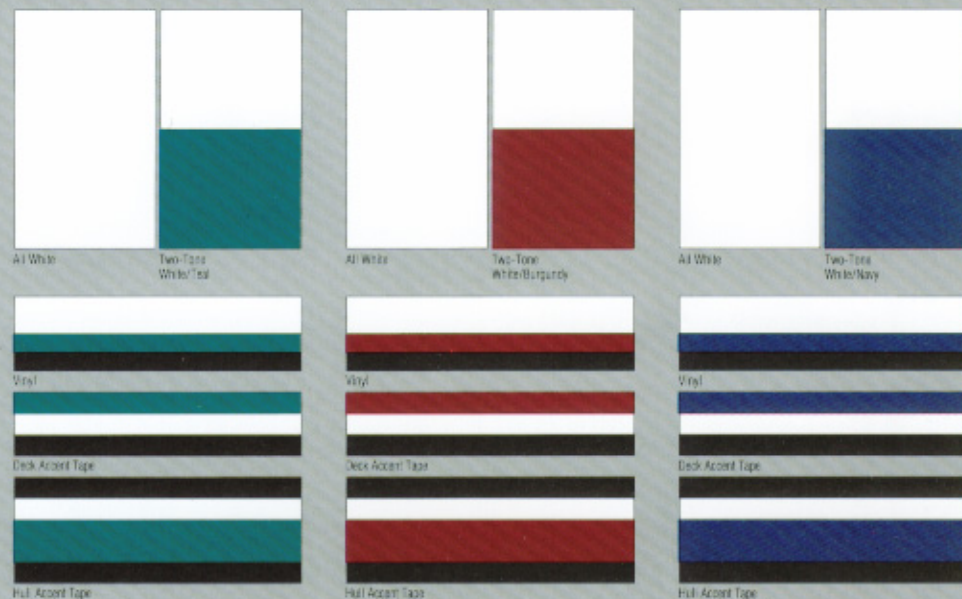

## STANDARD FEATURES

### Transom

- Stainless oval aft rail
- Swim ladder/assist rail, stainless steel, patented design (285/315/325)
- Swim platform, fiberglass integrated
- Swim platform storage compartment (wet) (365)
- Transom light
- Walk-through fiberglass transom door with storage

### Cockpit

- Adjustable helm seat
- Automatic bilge pump
- Bilge blower
- Binnacle controls (285)
- Cockpit cover and Bimini top, Sunbrella®
- Courtesy lights, cockpit
- Depth sounder (285/315/325)
- Dockside power with isolator (50' cable), battery charger, dual switch and adapters
- Dual deep cycle, high-cranking marine batteries with retainers
- Dual shifters/throttle (315/325/365)
- 12V DC receptacle
- Engine access hatches
- Engine compartment sound insulation
- Horn, single (285/315/325)
- Horns, dual (365)
- Instrumentation: tachometers, fuel, coolant temp., voltage, oil pressure, rudder position (325/365), synchronizing tachometer (315/325/365), stern drive trim indicators (285/315)
- Integrated step access to walk-around (365)
- Power steering (285/315)

- Power trim and tilt (285/315 /V/Os only)
- Rotating passenger seat
- Stainless steel grab rails: radar arch, behind helm, sides
- Stereo speakers
- Storage: under seats, sidewalls, transom door
- Trim tabs, hydraulic
- Water heater with heat exchanger
- Windshield, tinted/tempered, curved glass
- Windshield wiper, starboard (starboard and port, 365)

### Exterior and Trim

- Bow pulpit, integrated with anchor line rollers
- Hatches, 3 round (315/325/365)
- Hatches, 2 round (285)
- Navigation lights
- Vent louvers, stainless

### Construction, Design and Performance

- Balsa core reinforced deck and hull
- Counter-rotation
- Fender lockers, integrated foredeck (365)
- Non-skid walk-around deck
- Premium Armorcoat fade-resistant finish
- Props, nickel bronze (325/365)
- Props, stainless (285/315)
- Stainless steel hardware
- Stainless welded bow rails
- Stern bumper, vinyl (325/365)
- Vinyl: premium grade, heavy-duty with "memory"

### Cabin(s)

- Air make-up system (aft)
- Azium dressing area (365)
- Cabinetry, hand-crafted Formica, spring-hinged
- Carpeting, 44 oz. premium grade marine
- Curtains, privacy, aft cabin and vee-berth

- Dinette (main salon), converts to berth
- Electrical system control panel
- Entry door: plexiglass, lockable
- Fabrics, premium grade, designer-styled
- Hanging storage
- Indirect lighting
- Storage: vee-berth, sidewalls, hanging locker, beneath seats
- Table: stows in port sidewall (365), removable with 2 tops (315/325)
- Window curtains

### Head

- Enclosed head with vanity, sink, linen cabinet, shower head
- Full vanity with storage, mirror
- Marine head: wholding tank and pump-out
- Separate wet/dry areas (365)
- Storage, sidewall

### Galley

- 2-burner alcohol/electric stove (315/325/365)
- 1-burner alcohol/electric stove (285)
- 110/12-volt refrigerator
- Lighting (quartz, 365)
- Sink
- Storage: cabinets and drawers

1. Remote control spotlight
2. Deck sunpads
3. Transom washdown with showerhead
4. Cockpit refreshment center
5. Tilt steering wheel
6. Entertainment center with television, VCR, compact disc player
7. Dual companion seat swivels to three positions
8. Color-coordinated Sunbrella camper canvas
9. Transom storage lockers (285/315/325)

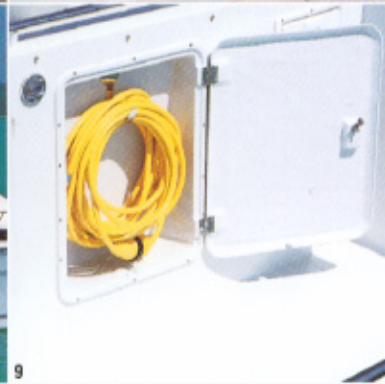

## OPTIONS

	365	325	315	285
AIR CONDITIONING/HEATING	a	a	a	a
BEDDING PACKAGE	s	a	a	a
BOTTOM PAINT	a	a	a	a
CANVAS, CAMPER (INC. MAIN SIDES)	a	a	a	a
CANVAS, COCKPIT	a	a	a	a
CANVAS, FULL (AFT, SIDE)	a	a	a	a
COCKPIT CARPET	a	a	a	a
COCKPIT GALLEY				a
COFFEEMAKER	a			
COMPASS	s	a	a	a
CO MONITOR	a	a	a	a
DECK SUNPAD	a	a	a	a
DINETTE		a	a	a
FLUSH OUT KIT			a	a
FRESH WATER ENGINE COOLING SYSTEM*	a	a		
GAS VAPOR DETECTOR	a	a	a	a
GEL COAT, TWO-TONE				
GENERATOR	a	a	a	a
GREY WATER SYSTEM	a	a	a	a
HALON FIREBOY	a	a	a	a
HATCH SCREENS	a	a	a	a
HEAD, TREATED DISCHARGE	a	a	a	a
HEAD, VAC-U-FLUSH	a	a	a	a
HORN, DUAL TRUMPET	s	a	a	a
HOUR METER	a	a	a	a
ICE MAKER, COCKPIT	a	a	a	a <sup>2</sup>
KITCHEN CENTER	a			
LIGHT, REMOTE FLOOD	a	a	a	a
MICROWAVE	a	a	a	a
NAVIGATION PACKAGE - VHF, LORAN		a	a	a
VHF, LORAN, RADAR		a	a	
VHF, LORAN, RADAR, AUTO PILOT, QUAD DATA	a			
OIL DRIP PAN			a	a
PROPS, HIGH ALT./HEAVY LOAD				a
RADAR ARCH	req	a	a	a
SEAT, STERN COUCH	a	a	a	a
LUXURY COCKPIT I	s	a	a	
LUXURY COCKPIT II		a	a	
SHOWER CURTAIN	s	s	s	a
SNAP-IN SUNBRELLA CABIN RUNNER	a	a	a	a
SPA W/JET PUMP	a			
STEERING, HYDRAULIC	s	a		
STEERING, TILT WHEEL	a	a	a	a
STEREO UPGRADE W/CD PLAYER	a			
STORAGE CRADLE	a	a	a	a
SWIM PLATFORM, TEAK INSERT			a	a
TABLE W/COCKPIT MOUNT	a	a	a	a
TELEVISION		a	a	a
TELEVISION/VCP CENTER	a			
TRANSOM STORAGE LOCKERS (3; 2 on 285)			a	a
TRANSOM WASHDOWN KIT	a	a	a	a
VEE-BERTH BULKHEAD	a	a	a	
VEE-BERTH SLEEPER				a
WINDLASS	a	a	a	a
WINDSHIELD WIPER, STARBOARD	s	a	a	a
WINDSHIELD WIPER, STARBOARD & PORT	s	a	a	a

a = available s = standard

\* Standard on diesel engines. <sup>2</sup> Requires cockpit galley.

Bedding Package: Sleepsack and pillow shams (365), sleepsack (325, 315, 285)

Luxury Cockpit I: Dual companion seats (one adjustable, one swivel)

Luxury Cockpit II: Dual companion seats as above, refreshment center, icebox.

## SPECIFICATIONS

	365	325	315	285
LOA/Transom to Bow:	39'136"	30'6"	30'6"/28'6"	28'11"/27'5"
Beam:	13'2"	11'	11'	10'2"
Fuel (gal.):	300	180	180	140
Water (gal.):	98	35	35	35
Max. Cruise Range (mi.):*	350	160	280	250
Passengers:	15	12	12	12
Bridge Clearance:	9'8"/10'9" w/radome	7'6"/9' w/arch	7'6"/9' w/arch	7'3"/8'6" w/arch
Cockpit Depth (helm):	44"	34"	34"	34"
Draft <sup>†</sup> :	38"	34"	40"	39"

\* Estimate. Actual cruise range may vary.  
<sup>†</sup> Drives† down where applicable.

365		
Power Ratings & Weights	Shaft HP	Boat & Engine Lbs.
Twin 300B/L-6 Diesel	292 EA	17,900
Twin 454XL/V-8	320 EA	17,500
Twin 502XL/V-8	380 EA	17,500

325		
Power Ratings & Weights	Shaft HP	Boat & Engine Lbs.
Twin 350 CID/V-8	235 EA	11,000
Twin 454XL/V-8	320 EA	11,500

315		
Power Ratings & Weights	Shaft HP	Boat & Engine Lbs.
Twin 3.2L/L-6 Diesel	187 EA	10,200
Twin 5.0L EFI/V-8	200 EA	10,100
Twin 5.8L EFI K/V-8	240 EA	10,400
Twin 351 CI/V-8	260 EA	10,300
Twin 454CI/V-8	295 EA	10,500

285		
Power Ratings & Weights	Shaft HP	Boat & Engine Lbs.
Twin 3.2L/L-6 Diesel	187 EA	8,850
Twin 5.0L HO/V-8	190 EA	8,700
Twin 5.0L EFI/V-8	200 EA	8,790
Twin 5.8L EFI K/V-8	240 EA	9,140
Twin 351CI/V-8	260 EA	9,060



# FOUR WINNS®

A Subsidiary of OMC®

4 Winn Way  
Cadillac, Michigan 49601  
(616) 775-1351



Compliments of:

An important note about information in this catalog... Every effort has been made to insure that this catalog includes complete and accurate information. However, since the time of printing, some information may have been revised. Also some equipment shown on Four Winns boats within this catalog is available at extra cost. Since we do reserve the right to make changes at any time, without notice, in prices, colors, equipment, specifications and models, we suggest that you check with your Four Winns dealer for complete and current information. OMC Cobra® and OMC King Cobra® are trademarks of Outboard Marine Corporation. Armoroote is a registered trademark of Cook Composites & Polymers, Inc. Velcro is a registered trademark of Velcro USA, Inc. Sunbrella is a registered trademark of Glenn Raven Mills, Inc. Ojeff is a registered trademark of R.D. Stallion & Associates, Inc. Four Winns / 4 Winn Way / Cadillac, MI 49601 / (616) 775-1351